

5V200 Series

Solenoid Valve / Air piloted Valve



We make the difference



Own Independent Intellectual Property Rights

APPL:
2013303668314.7



5V210-08



NEW
5V100
5V200
5V300
5V400
JSY
JEL10
JEL-JN
551
4F210
JELVD
DN
DSN
DN/DSN A
MA
MAC
MA/MAC A
MAL
MALC
MAL/MALC A
SDA

Features

- Single solenoid valve uses new design with piston reset and improve steadiness, functionality and life time.
- We guarantee inner hole with Ra0.1 roughness within our new processing.
- Special treatment to take care of inner hole to reduce the resistance, for the spool adding anti-friction seal to improve the stability during movement.
- For our manufacturing process we use imported HNBR to reduce friction.
- To import German high standard special grease which provides film in order to reduce the friction.
- To introduce Taiwan high precise injection mould and seals die, to enhance precision and stability.
- New visual style, synchronized with global outstanding product standard.
- Adding the logo on behalf of the company innovation for individual market recognition on the product which has design patent.

Ordering Code

5V	2	10	08	B	F	AC220V	W	F
Specification	Series Code	Coil and Position	Port Size	Connection and Initial status	Reset form and color	Standard Voltage	Wiring	Joint
5V:2(3) way solenoid valve	200 Series	10: Single coil 5/2 way	06:1/8"	Blank: Threaded	Blank: Air reset (red front and back cover)	DC12V	Blank: Brown with light terminal	1F-20F
5A:2(3) way air pilot valve		20: Double coil 5/2 way	08:1/4"	B: Namur	F: Air reset (black front and back cover)	DC24V	LD1: White with light terminal	
		30C: Double coils 5/3 way-closed			S: Spring reset (black front and back cover)	AC24V	W: Lead wire	
		30E: Double coils 5/3 way-exhausted			(*Note)	AC110V		
		30P: Double coils 5/3 way-pressed				AC220V		

- *Note:**
- Red and black colour is available for option.
 - Only black colour is available for spring reset products.
 - Only black colour and spring reset is available for 310, 410 series single coil valve.

Specification

Model	5V210-06	5V220-06	5V230C-06	5V230E-06	5V230P-06	5V210-08	5V220-08	5V230C-08	5V230E-08	5V230P-08
	5A210-06	5A220-06	5A230C-06	5A230E-06	5A230P-06	5A210-08	5A220-08	5A230C-08	5A230E-08	5A230P-08
Valve Type	5/2 way		5/3 way			5/2 way		5/3 way		
Effective Cross Section Area	14 mm ² (CV=0.78)		12 mm ² (CV=0.67)			16 mm ² (CV=0.89)		12 mm ² (CV=0.67)		
Port Size	Inlet, Outlet, Exhaust Port = G 1/8"					Inlet, Outlet = G 1/4", Exhaust Port = G 1/8"				
Working Medium	40 Micron Filtered Air									
Operation	Internal piloted									
Working-pressure	0.15 ~ 0.8 MPa									
Max. Test Pressure	1.2 MPa									
Ambient Temperature	-20 ~ 70 °C									
Operating Voltage Tolerance	DC: ± 10% AC: ± 15%									
Power Consumption	AC: 3.5 VA DC: 3.0 W									
Connector Protection	F Class, IP 65									
Wiring / Connector	Cable / Lead Wire or DIN Connector									
Switching Frequency	5 Cycles / Sec.									
Response Time	0.05 Sec.									

Internal Structure

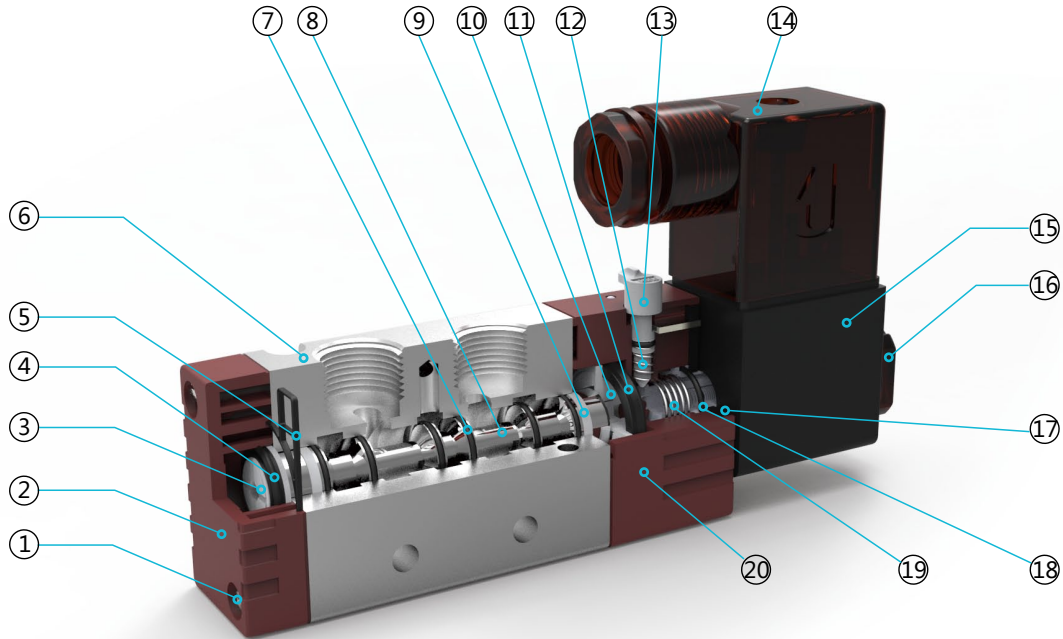

Parts

Number	Name	Number	Name	Number	Name
1	Cross slot pan screw	8	Valve spool	15	Coil
2	Back cover	9	Anti-friction seal	16	Coil nut
3	Piston	10	Piston	17	Connecting part
4	Y ring	11	Y ring	18	O ring
5	Anomalous seal	12	Spring	19	Plunger
6	Valve body	13	Manual ride spindle	20	Piloted valve base
7	Flat ring	14	Terminal		

Flow Chart

Model : 5V210-06

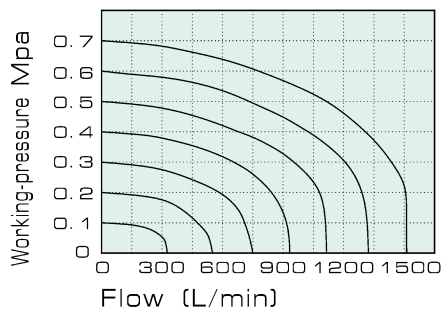

Model : 5V210-08

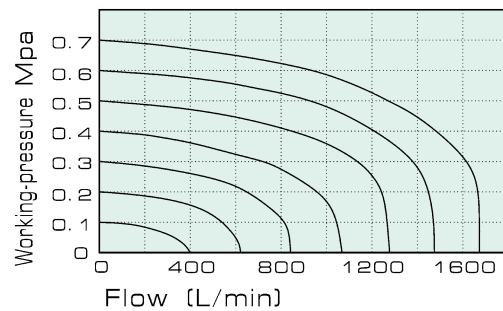

NEW

5V100

5V200

5V300

5V400

JSY

JEL10

JEL-JN

551

4F210

JELVD

DN

DSN

DN/DSN A.

MA

MAC

MA/MAC A.

MAL

MALC

MAL/MALC A.

SDA

5V200 Series

Solenoid Valve / Air piloted Valve



We make the difference

Overall Dimension

5V210-06

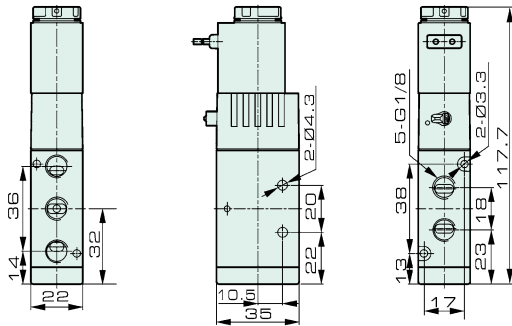

5V210-06

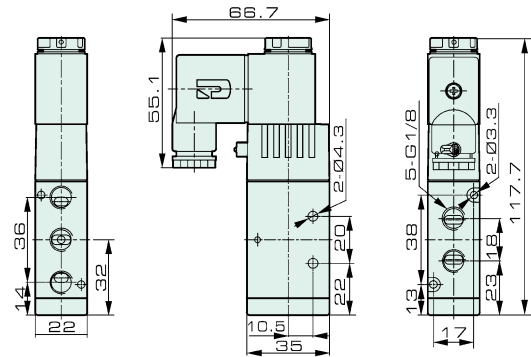

5V220-06

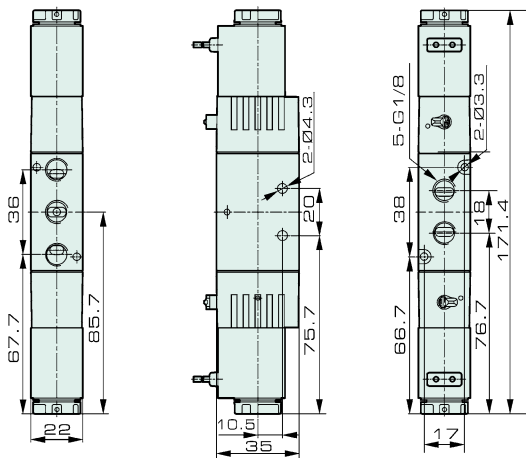

5V220-06

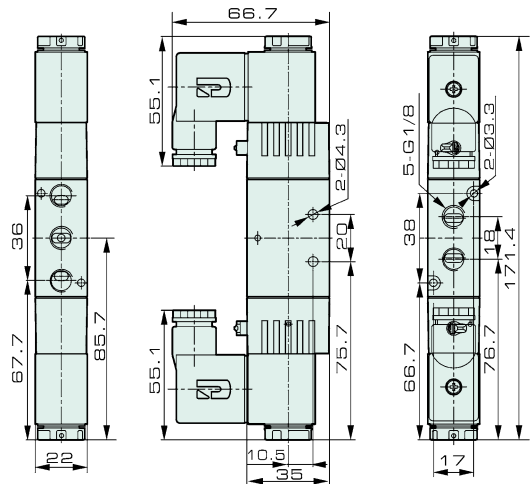

5V230-06

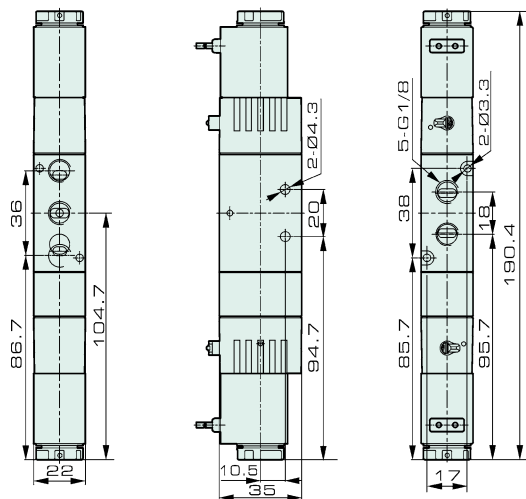

5V230-06

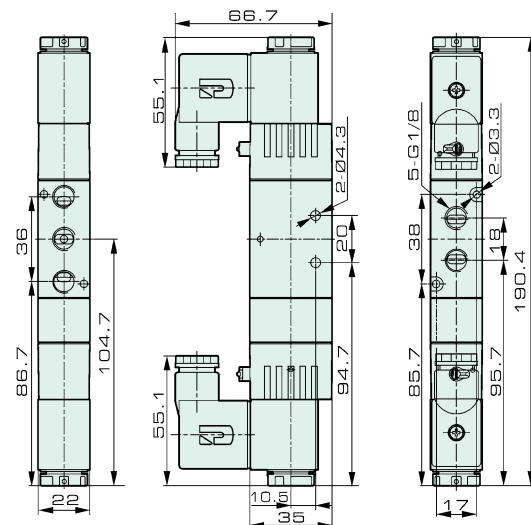

Overall Dimension

5V210-08

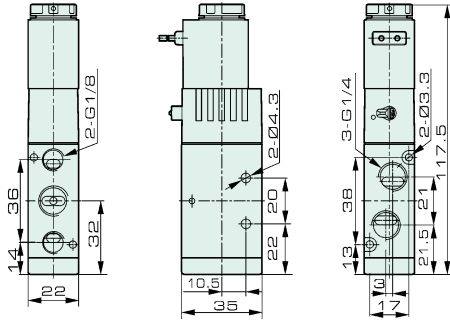

5V210-08

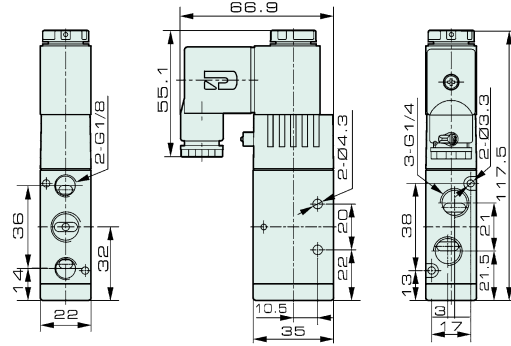

5V220-08

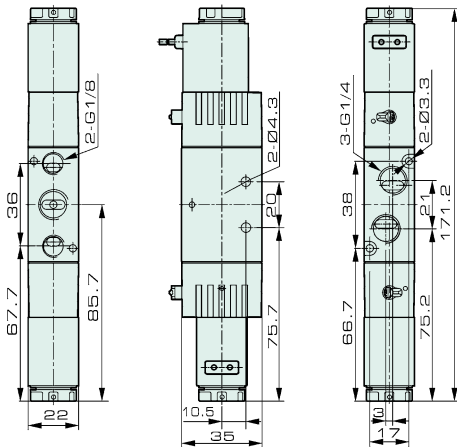

5V220-08

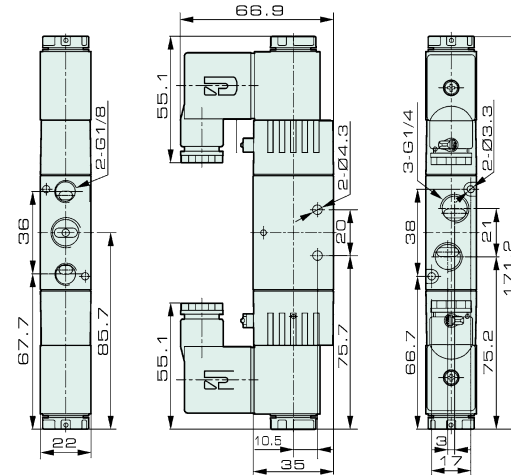

5V230-08

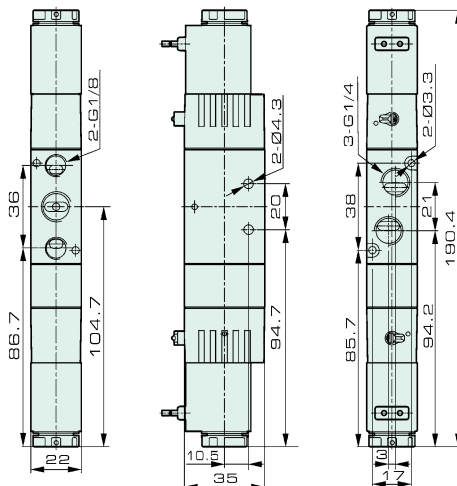

5V230-08

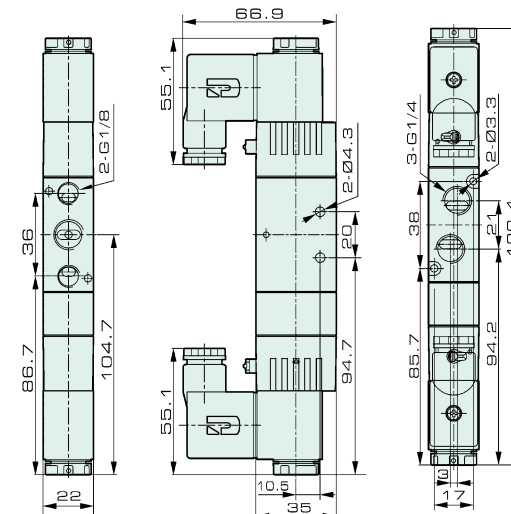

NEW

5V100

5V200

5V300

5V400

JSY

JEL10

JEL-JN

551

4F210

JELVD

DN

DSN

DN/DSN A.

MA

MAC

MA/MAC A.

MAL

MALC

MAL/MALC A.

SDA