

4H Series Hand Pull Valve



We make the difference

Valve

- DJF
- JELMP
- JELP/G
- MCS
- 4V100
- 4V200
- 4V300
- 4V400
- Manifold
- SV
- 3V1
- JEL
- 3VJZF
- 4VJZF
- MVSD
- VF, VZ
- BM
- Diaphragm
- Coil
- 2V
- 2W
- 2W(Big)
- 2P
- 2L
- VX
- PU
- PU225
- 2Q
- JEL5404
- JEL6213
- BU
- Pulse
- JELJZF
- 4H**
- TSV
- MPV
- 4HV
- HV, K
- 4R
- FV
- MSV
- JM
- ASC, RE
- QE, QEA
- ST
- HSV



Ordering Code

4H	2	10	C	06	L
Specification	Series Code	Position Number	Middle Position	Port Size	Type
4H: 5/2(3) Way	2: 200 Series 3: 300 Series 4: 400 Series	10: Single head two position 30: Single head three position	C: Mid-position closed E: Mid-position exhausted P: Mid-position pressured	06: G 1/8" 08: G 1/4" 10: G 3/8" 15: G 1/2"	Blank: 5/2 way lock type L: 5/3 way lock type S: 5/2 (3) way spring return type

Specification

Model	4H210-06	4H210-08	4H230-08	4H310-08	4H310-10	4H330-10	4H410-15	4H430-15
Working Medium	40 Micron Filtered Air							
Operation	Direct							
Effective Cross Section Area	14 mm ² (CV=0.78)	16 mm ² (CV=0.89)	12 mm ² (CV=0.67)	25 mm ² (CV=1.4)	30 mm ² (CV=1.68)	18 mm ² (CV=1.00)	50 mm ² (CV=2.79)	30 mm ² (CV=1.68)
Port Size	Inlet, Outlet, Exhaust Port = G 1/8"	Inlet, Outlet = G 1/4" Exhaust Port=G 1/8"	Inlet, Outlet, Exhaust Port = G 1/4"	Inlet, Outlet, Exhaust Port = G 1/4"	Inlet, Outlet = G 3/8" Exhaust Port = G 1/4"		Inlet, Outlet, Exhaust Port = G 1/2"	
Working Pressure	0 ~ 0.8 MPa							
Working Temperature	0 ~ 60 °C							

Overall Dimension

4H Series

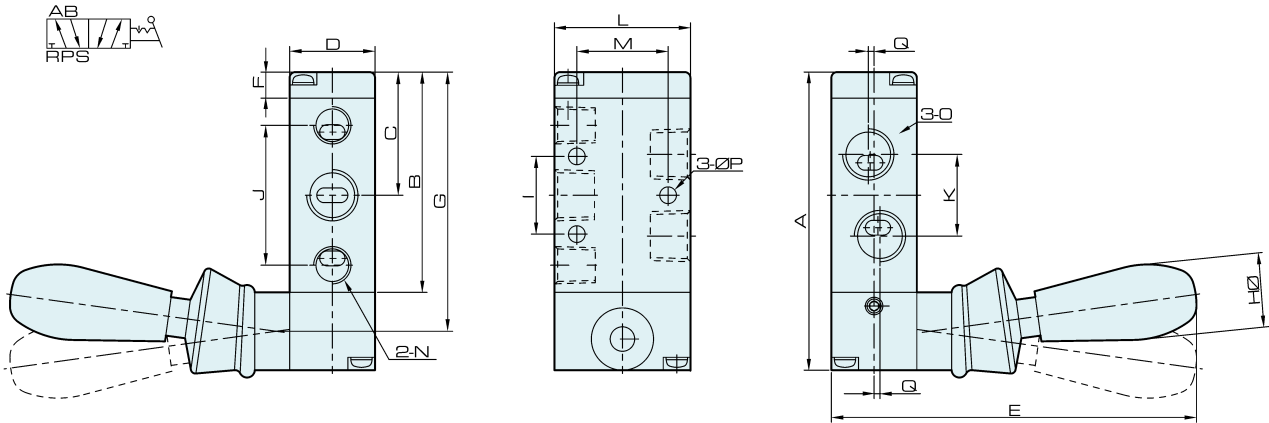

Valve

DJF
JELMP
JELP/G
MCS
4V100
4V200
4V300
4V400
Manifold
SV
3V1
JEL
3VJZF
4VJZF
MVSD
VF, VZ
BM
Diaphragm
Coil
2V
2W
2W(Big)
2P
2L
VX
PU
PU225
2Q
JEL5404
JEL6213
BU
Pulse
JELJZF
4H
TSV
MPV
4HV
HV, K
4R
FV
MSV
JM
ASC, RE
QE, QEA
ST
HSV

Dimension

Symbol	4H210-08(06)	4H230-08(06)-S (Automatic Re-bound)	4H310-10(08)	4H330-10(08)-S (Automatic Re-bound)	4H410-15	4H430-15-S (Automatic Re-bound)
	4H230-08(06)-L		4H330-10(08)-L		4H430-15-L	
A	76	95	96	115	126	147
B	56.5	75.5	72	91	102	123
C	31.5	31.5	40	60	55.5	76.5
D	22	22	27	27	34	34
E	95	95	100	100	110	110
F	6.5	6.5	7.5	7.5	7.5	7.5
G	66.5	85.5	84	103	114	135
H	18	18	18	18	18	18
I	20	20	24	24	28	28
J	36	36	45	45	63	63
K	21	21	24	24	36	36
L	35	35	40	40	50	50
M	21	21	27	27	35	35
N	G 1/8	G 1/8	G 3/8	G 3/8	G 1/2	G 1/2
O	G 1/4 (G 1/8)	G 1/4 (G 1/8)	G 3/8 (G 1/4)	G 3/8 (G 1/4)	G 1/2	G 1/2
P	4.3	4.3	4.3	4.3	5.5	5.5
Q	1.5 (-)	1.5 (-)	2 (-)	2 (-)	-	-