



Ordering Code

| | |
|---------------------|------------|
| HSV | 01 |
| Series | Port Size |
| Hand sliding series | 01: G 1/8" |
| | 02: G 1/4" |
| | 03: G 3/8" |
| | 04: G 1/2" |

Feature

2/3 Hand sliding valve can be used as switch of Air source. When Air source is switched off, the remained air in system can be released.

Specification

| Model | HSV-01 | HSV-02 | HSV-03 | HSV-04 |
|---------------------|-----------------------------|--------|--------|--------|
| Port Size | G 1/8" | G 1/4" | G 3/8" | G 1/2" |
| Orifice Size | 4 mm | 7 mm | 10 mm | 12 mm |
| Working Medium | Filtered and Compressed Air | | | |
| Working Pressure | 0~1.0 MPa | | | |
| Ambient Temperature | 5~60 °C | | | |
| Operating Force | 20 N | | | |

Overall Dimension

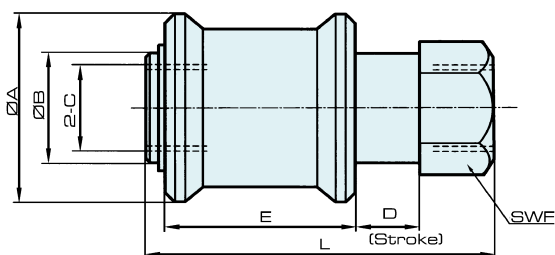

Dimension

| Model/ Symbol | A | B | C | D | E | F | L |
|------------------|----|----|-------|----|----|----|----|
| HSV-01 | 25 | 13 | G 1/8 | 9 | 28 | 14 | 48 |
| HSV-02 | 30 | 18 | G 1/4 | 11 | 32 | 19 | 58 |
| HSV-03 | 35 | 21 | G 3/8 | 14 | 39 | 22 | 68 |
| HSV-04 | 40 | 26 | G 1/2 | 15 | 45 | 27 | 80 |

Valve

DJF
JELMP
JELP/G
MCS
4V100
4V200
4V300
4V400
Manifold
SV
3V1
JEL
3VJZF
4VJZF
MVSD
VF, VZ
BM
Diaphragm
Coil
2V
2W
2W(Big)
2P
2L
VX
PU
PU225
2Q
JEL5404
JEL6213
BU
Pulse
JELJZF
4H
TSV
MPV
4HV
HV, K
4R
FV
MSV
JM
ASC, RE
QE, QEA
ST
HSV