

Fluid control valve(2/2way)



2KS Series (Internally piloted and normally opened)



2KS

Specification

Type\Item	Port size ①	Orifice size (Φmm)	Cv	Valid area or section(mm ²)	Weight ②(g)	Max. operating pressure differentia		Proof pressure	
						MPa	psi	MPa	psi
2KS150-15	1/2"	15.0	5.50	100.0	680	Max:0.7 Min:0.05	Max:100 Min:10	1.5	220
2KS200-20	3/4"	20.0	9.50	170.0	880				
2KS250-25	1"	25.0	12.50	220.0	1125				
2KS320-32	1 1/4"	35.0	23.00	420.0	2710				
2KS400-40	1 1/2"	40.0	31.00	560.0	3260				
2KS500-50	2"	50.0	49.00	880.0	4310				

- ① PT thread, NPT thread and G thread are available.
- ② The weight in the table is the terminal valve's weight, 2S150-250 series grommet valve's weight is 10g less than terminal's. 2S320-500series grommet valve's weight is 20g less than terminal's.

Symbol



Product feature

1. Indirect acting (Internal pilot) and normally opened type 2/2 way solenoid valve. Its can change direction quickly and has large flow.
2. It is compact, small and light weight. It is easy to install and dismantle;
3. The valve body is made of SUS304. The coil has a Heat resistance classification of Class B. The standard seal material is FPM-F. Please contact us if other material are required.
4. The protection class of the coil is IP65 and there is a choice for grommet or terminal electrical entry.

Valve's specification

Acting	Internally piloted			
Initial stats	Normally opened			
Adaptable fluid ①	Air, Water, Oil			
Viscosity limit	Under 20CST			
Ambient and fluid temperature(°C)	Water	Air	Oil	Ambient
	Max. 80	90	80	70
	Min. 1	-20 ②	-10 ③	-20

- ① Note: Please refer to P121 for detail of other's fluid.
- ② Note: Dew point: -20(°C) or less. ③ Note: 50CST or less.

Inner structure

2KS150(Grommet)

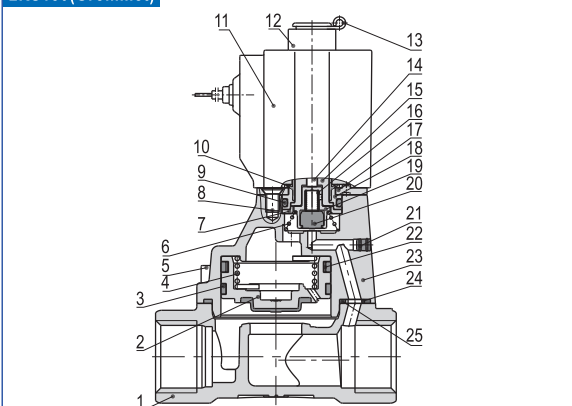

No.	Item	No.	Item	No.	Item	No.	Item
1	Body	8	Screw	15	Movable core	22	Spring
2	Piston	9	O-ring	16	Spring	23	Cover
3	Wear ring	10	Washer	17	Fixed plate	24	Bushing
4	Spring	11	Coil assembly	18	Fixed cap	25	O-ring
5	Screw	12	Position ring	19	Airtight bushing		
6	Spring	13	E Clip	20	Airtight ring		
7	Fixed ring	14	Man drill	21	Plug		

Coil specification

Valve type	Coil type	Power type	Frequency (Hz)	Voltage range	Electrical entry	Power Consumption (VA/W)	Insulation	Temp. rise(°C)
2KS150 2KS200 2KS250	CDA116 CLA116	AC	50	± 15%	(Terminal) (CDA)	15.0VA	Class B	50
			60			11.0VA		40
2KS320 2KS400 2KS500	CDA170 CLA170	AC	50	± 15%	(Grommet) (CLA)	6.5W		30
			60			35.0VA		65
						30.0VA		60
						10.5W		40
		DC	-	± 10%				

Ordering code

2KS 150 15 A □ □

- Model**
 - 2KS: 2/2 way internally piloted and normally opened
- Orifice size**
 - 150: Φ15mm
 - 200: Φ20mm
 - 250: Φ25mm
 - 320: Φ32mm
 - 400: Φ40mm
 - 500: Φ50mm
- Port size**

Orifice series	Port size
150: Φ15mm	15: 1/2"
200: Φ20mm	20: 3/4"
250: Φ25mm	25: 1"
320: Φ32mm	32: 1 1/4"
400: Φ40mm	40: 1 1/2"
500: Φ50mm	50: 2"
- Thread type**
 - Blank: PT
 - T: NPT
 - G: G
- Electrical entry**
 - Blank: Terminal
 - I: Grommet
- Voltage**
 - A: AC220V
 - B: DC24V
 - C: AC110V
 - E: AC24V
 - F: DC12V

Ordering code of accessories

Ordering code of accessories is the same as 2S series valve's, Please refer to P98 for details of ordering code.

Note: ⚠ 320\400\500 series valves do not have mounting accessories.



Fluid control valve(2/2way)

2KS Series (Internally piloted and normally opened)

Flow chart

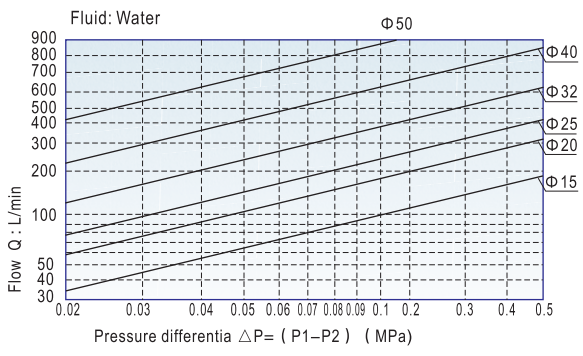
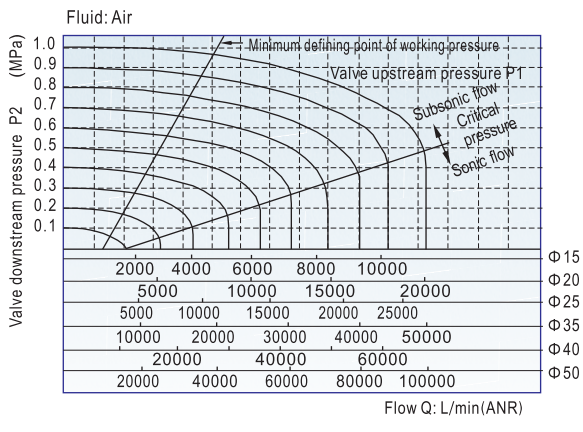

Dimensions

2KS150-250(Terminal)

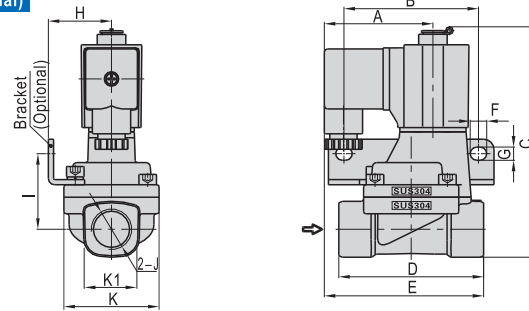

2KS320-500(Terminal)

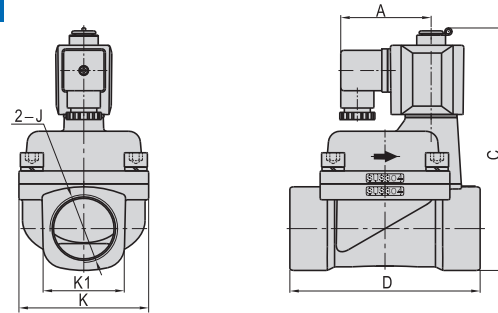

Type\Item	A	B	C	D	E	F	G	H	I	J	K	K1
2KS150-15	52.5	65	112.3	70	77	8	6.4	30.5	36.5	1/2"	46	27.5
2KS200-20	52.5	75	120.8	82	78.5	8	6.4	34	40	3/4"	53	33.5
2KS250-25	52.5	80	129.3	92	81	8	6.4	36	44.5	1"	59	40.5
2KS320-32	62.7	-	159.6	125	-	-	-	-	-	1 1/4"	80	52
2KS400-40	62.7	-	167.1	132	-	-	-	-	-	1 1/2"	90	58
2KS500-50	62.7	-	182.1	150	-	-	-	-	-	2"	100	70

2KS150-250(Grommet)

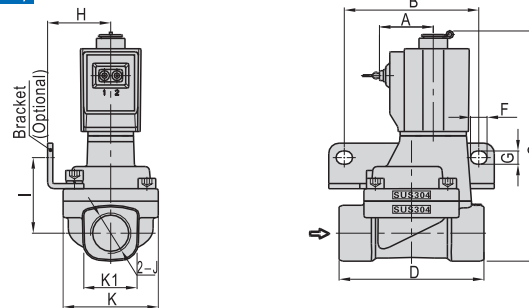

2KS320-500(Grommet)

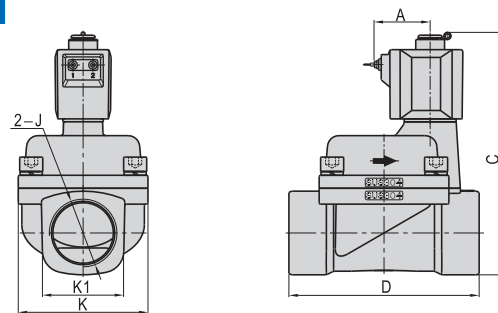

Type\Item	A	B	C	D	F	G	H	I	J	K	K1
2KS150-15	26	65	112.3	70	8	6.4	30.5	36.5	1/2"	46	27.5
2KS200-20	26	75	120.8	82	8	6.4	34	40	3/4"	53	33.5
2KS250-25	26	80	129.3	92	8	6.4	36	44.5	1"	59	40.5
2KS320-32	38.8	-	159.6	125	-	-	-	-	1 1/4"	80	52
2KS400-40	38.8	-	167.1	132	-	-	-	-	1 1/2"	90	58
2KS500-50	38.8	-	182.1	150	-	-	-	-	2"	100	70



2KS