



Rodless magnetic cylinder—RMS Series

Product series

Series name	Mounting type			Acting type	Bore size
	Basic	LB	FA		
RMS Series	●	●	●	Double acting	16
	●	●	●		20
	●	●	●		25
	●	●	●		32
	●	●	●		40
RMSP Series	●	●	●	Double acting	16
	●	●	●		20
	●	●	●		32
RMSF Series	●	●	●	Double acting	16
	●	●	●		20
	●	●	●		25
	●	●	●		32
	●	●	●		40
Page	356			358	

Installation and application

1. The maxi load to move must be less than the theoretical holding force.

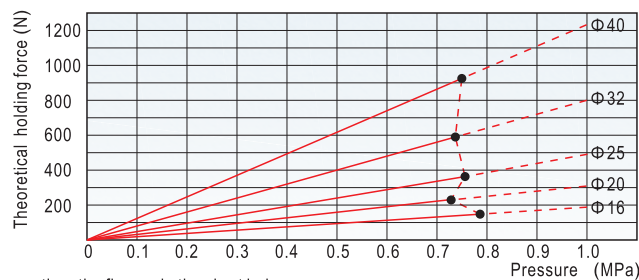

2. Horizontal mounting, the permissible radial load must be lower than the figures in the chart below.

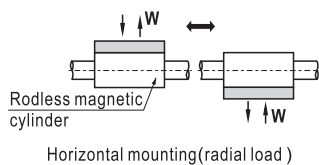

Bore size	Max. load W
16	2.8kg
20	4.7kg
25	6.8kg
32	9.7kg
40	15.8kg

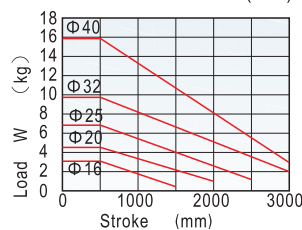

3. Vertical mounting, the allowable direction moment must be lower than the figures in the chart below, the dimensions of geometrical can be determined by the relation graph between loading and stroke.

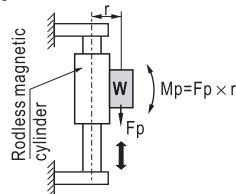

Bore size	Allowable direction moment Mp
16	1.20kgf · m
20	2.45kgf · m
25	3.92kgf · m
32	8.83kgf · m
40	13.7kgf · m

Note) Loading should be used with oriented device, example:

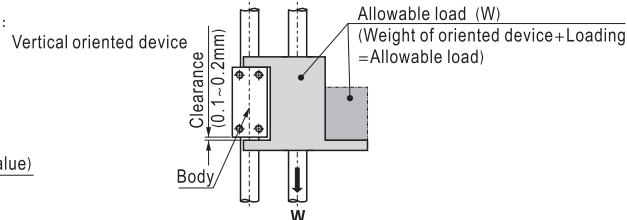
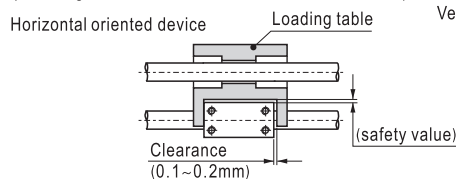

- Dirty substances in the pipe must be eliminated before cylinder is connected with pipeline to prevent the entrance of impurities into the cylinder.
- The medium used by cylinder shall be filtered to 40 μm or below.
- If the cylinder is dismantled and stored for a long time, pay attention to conduct anti-rust treatment to the surface. Anti-dust jam cap shall be added in air inlet and outlet ports.



RMS



Rodless magnetic cylinder



RMS Series



Specification

Series name	RMS, RMSF Series					RMSP Series		
Bore size (mm)	16	20	25	32	40	16	20	32
Acting type	Double acting							
Fluid	Air(to be filtered by 40 μ m filter element)							
Operating pressure	0.15~0.7MPa(23~100psi)(1.5~7bar)							
Proof pressure	1.0MPa(145psi)(10.0bar)							
Temperature °C	-10~60							
Speed range mm/s	50~400							
Stroke tolerance mm	0~250 ^{+1.0} ₀ 251~1000 ^{+1.4} ₀ 1001~ ^{+1.8} ₀							
Cushion type	Variable cushion+Fixed cushion							
Port size ①	M5 × 0.8		1/8"		1/4"	M5 × 0.8		1/8"
Safe holding force N	140	200	360	550	850	140	200	550

① PT thread、NPT and G thread are available.

Stroke

Bore size (mm)	Standard stroke (mm)										Max. stroke(mm)						
16	50	100	150	200	250	300	350	400	450	500	1500						
20	50	100	150	200	250	300	350	400	450	500	600	700	750	800	900	1000	2000
25	50	100	150	200	250	300	350	400	450	500	600	700	750	800	900	1000	2500
32	50	100	150	200	250	300	350	400	450	500	600	700	750	800	900	1000	3000
40	50	100	150	200	250	300	350	400	450	500	600	700	750	800	900	1000	3000

Note) Consult us for non-standard stroke.

Symbol

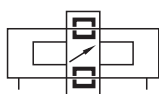

Product feature

1. This magnetic cylinder is basically a pneumatic rodless cylinder featuring a mobile piston fitted with annular magnets. The mobile carriage is also equipped with magnets to provide magnetic coupling (carriage/piston). The carriage slide freely along the main tube.
2. It is dust-proof as the isolation between the carriage and piston.
3. It is compact in space.
4. The non adjustable rubber bumpers and the adjustable pneumatic cushioning on both ends of the cylinder ensure the smooth action.



RMS

Ordering code

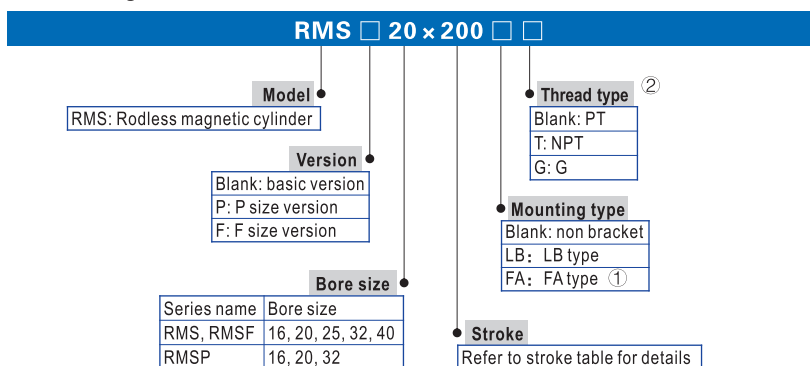

Remark:

① RMSF40 series do not have FA mounting accessories.

② Blank on thread code means metric M thread. There is only metric thread for Φ 16. If G or NPT thread is needed, please comment.



Rodless magnetic cylinder

RMS Series

Inner structure and material of major parts

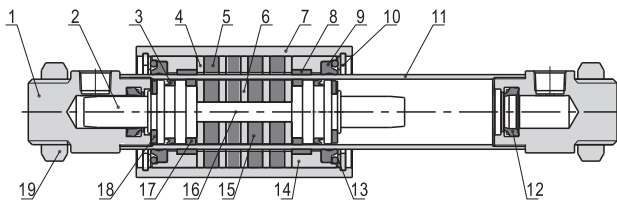

NO.	Item	Material
1	End cap	Aluminum alloy
2	Piston	Aluminum alloy
3	Piston seal	TPU
4	Magnet washer	Carbon steel
5	Magnet	Rare-earth material
6	Magnet washer	Carbon steel
7	Body	Aluminum alloy
8	Wear ring	Wear resistant material
9	Scraping dust ring	Plastics
10	C Clip	Spring steel
11	Barrel	Stainless steel
12	Cushion O-ring	TPU
13	Washer	Stainless steel
14	Cover	Aluminum alloy
15	Magnet	Rare-earth material
16	Connecting rod	Stainless steel
17	Wear ring	Wear resistant material
18	Bumper	NBR
19	Nut	Stainless steel

Dimensions

RMS, RMS-P

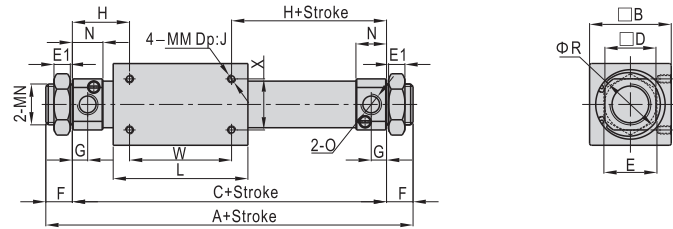

RMS-F

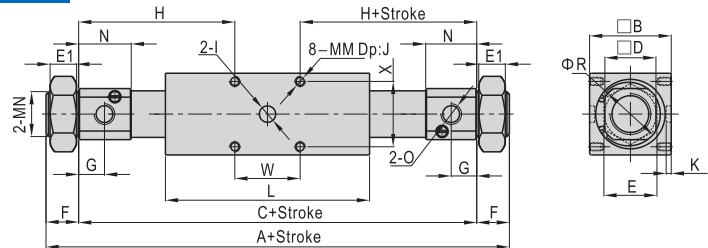

Model\Item	A	B	C	D	E	E1	F	G	H	I	J	K
RMS16	103		83		14	4	10	5.5	24	-	5	-
RMSF16	112	35	92	20	14	4	10	7.5	29	-	7	-
RMSF16	205		181		24	8	12	20	77.5	8	7.5	3
RMS20	132		106		26	8	13	7.5	28	-	5.5	-
RMSF20	141	40	115	25	26	8	14	10	37.5	-	7	-
RMSF20	217		185		29	7	16	15	76	8	8.5	2.5
RMS25	137		111		32	8	13	7.5	30.5	-	7.5	-
RMSF25	238	46	206	30	29	7	16	20	85	10	10	3
RMS32	156		124		32	8		8	37	-	8	-
RMSF32	165	60	133	36	32	8	16	10	41.5	-	8	-
RMSF32	270		238		36	7		28	94.6	10	12.5	3.5
RMS40	182		150		41	10		11	45	-	9	-
RMSF40	327	70	295	46	46	8	16	25	122	12	16	4.5

Model\Item	L	MM	MN	N	O	R	X	W
RMS16	57	M4 × 0.7	M10 × 1.0	10			19	35
RMSF16	57	M4 × 0.7	M10 × 1.0	14.5	M5 × 0.8	22	25	34
RMSF16	80	M5 × 0.8	M16 × 1.5	34			26	26
RMS20	66	M4 × 0.7	M20 × 1.5	15	1/8"		25	50
RMSF20	66	M5 × 0.8	M20 × 1.5	19.5	1/8"	29	30	40
RMSF20	90	M5 × 0.8	M22 × 1.5	29.5			32	32
RMS25	70	M5 × 0.8	M26 × 1.5	15	1/8"		30	50
RMSF25	90	M6 × 1.0	M22 × 1.5	37.5	1/8"	33.5	36	36
RMS32	80		M26 × 1.5	16	1/8"			
RMSF32	80	M6 × 1.0	M26 × 1.5	20.5	1/8"	39.5	40	50
RMSF32	110		M30 × 1.5	48			48	48
RMS40	92	M6 × 1.0	M32 × 2.0	22	1/4"		40	60
RMSF40	130	M8 × 1.25	M38 × 1.5	44.5	1/4"	49.5	56	50



RMS

Rodless magnetic cylinder



RMS Series

Ordering code of accessories

F-RMS 32 LB

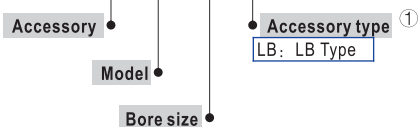

① The list accessories are for RMS cylinder. Accessories that are adaptable to other cylinder are not shown. Please refer to accessory list for selection and ordering information.

Accessory selection

Accessories\Cylinder model	RMS	RMSP	RMSF
Mounting accessories			
LB	●	●	●
FA	●	●	●

Dimensions

RMS-LB, RMSP-LB

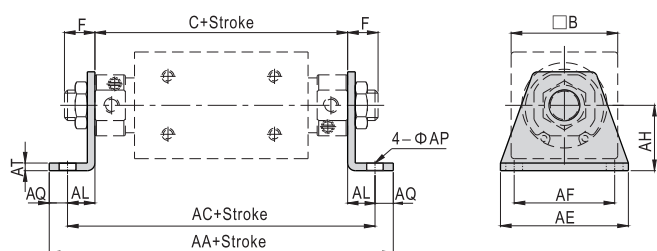

Bore size\Item	AA		AC		C		F	
	RMS	RMSP	RMS	RMSP	RMS	RMSP	RMS	RMSP
16	113	122	101	110	83	92	10	10
20	158	167	142	151	106	115	13	14
25	167	-	151	-	111	-	13	-
32	184	193	170	179	124	133	16	16
40	216	-	196	-	150	-	16	-

Bore size\Item	AE	AF	AH	AL	AP	AQ	AT	B
	16	42	33	20	9	5.5	6	2.5
20	43	30	23	18	6.5	8	3	40
25	54	40	26	20	6.5	8	4	46
32	62	46	33	23	7	7	4	60
40	75	55	38	23	9	10	5	70

RMS-FA, RMSP-FA

Φ16~Φ32

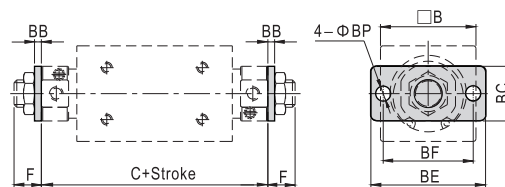

Φ40

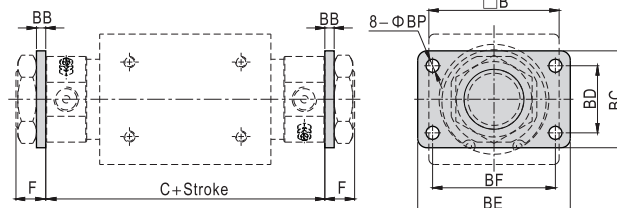

Bore size\Item	B	BB	BC	BD	BE	BF	BP	C		F	
	RMS	RMSP	RMS	RMSP	RMS	RMSP	RMS	RMSP	RMS	RMSP	
16	35	2.5	20	-	42	33	5.5	83	92	10	10
20	40	4	34	-	75	60	7	106	115	13	14
25	46	4	40	-	75	60	7	111	-	13	-
32	60	4	40	-	75	60	7	124	133	16	16
40	70	5	52	36	82	66	7	150	-	16	-

RMSF-FA

Φ16~Φ25

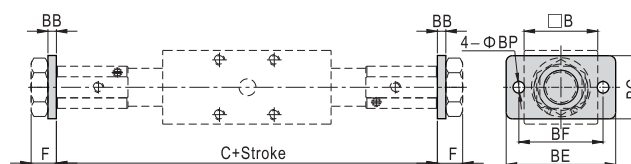

Φ32

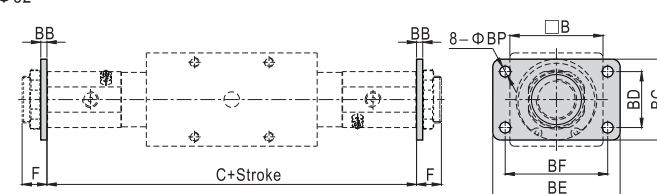

Bore size\Item	B	BB	BC	BD	BE	BF	BP	C	F
	16	35	4	30	-	52	40	5.5	181
20	40	4	38	-	64	50	6.5	185	16
25	46	4	38	-	64	50	6.5	206	16
32	60	4	50	36	84	70	6.5	238	16

List for ordering code of accessories

Bore size\accessories	Cylinder model	Mounting accessories	
		LB	FA
16	RMS	F-RMS16LB	F-PB12FA
	RMSP	F-RMS16LB	F-PB12FA
	RMSF	F-RMSF16LB	F-M12FA
20	RMS	F-RMS20LB	F-MF20FA
	RMSP	F-RMS20LB	F-MF20FA
	RMSF	F-RMSF20LB	F-MA20FA
25	RMS	F-RMS25LB	F-MF25FA
	RMSP	F-RMS25LB	F-MF25FA
	RMSF	F-RMSF25LB	F-MA20FA
32	RMS	F-RMS32LB	F-MF25FA
	RMSP	F-RMS32LB	F-MF25FA
	RMSF	F-RMSF32LB	F-MA40FA
40	RMS	F-RMS40LB	F-MF40FA
	RMSF	F-RMSF40LB	-



RMS

