

# Cylinder joint accessory

## I Knuckle



### Ordering code

**F-M16X150 I**

Accessories code

Knuckle

I: I Knuckle

Screw thread

M3: M3
M4: M4
M5: M5
M6: M6
M8: M8
M10: M10
M12: M12
M14: M14
M16: M16
M18: M18
M20: M20
M22: M22
M26: M26
M27: M27
M36: M36
M42: M42

Thread pitch

Screw thread	Thread pitch
M3	050: 0.5mm
M4	070: 0.7mm
M5	080: 0.8mm
M6	100: 1.0mm
M8, M10, M12	125: 1.25mm
M14, M16, M18	150: 1.5mm
M20, M22, M26	
M27, M36, M42	200: 2.0mm

### Table for I knuckle and cylinder

Accessory	Cylinder							SE							SI/SIF											
	32	40	50	63	80	100	125	32	40	50	63	80	100	125	160	200	32	40	50	63	80	100	125	160	200	
F-M10X125I	●																●									
F-M12X125I		●																●								
F-M16X150I			●		●													●	●							
F-M20X150I						●	●												●	●						
F-M27X200I																									●	
F-M36X200I																									●	●

Accessory	Cylinder				SGC				SC/SCF/SU/SUF				JSI														
	125	160	200	250	32	40	50	63	80	100	32	40	50	63	80	100	125										
F-M10X125I																											
F-M12X125I																											
F-M14X150I																											
F-M16X150I																											
F-M18X150I																											
F-M20X150I																											
F-M22X150I																											
F-M26X150I																											
F-M27X200I																											
F-M36X200I																											
F-M42X200I																											

Accessory	Cylinder				MI				MPG																		
	8	10	12	16	20	25	32	40	6	8	10	12	16														
F-M3X050I																											
F-M4X070I																											
F-M5X080I																											
F-M6X100I																											
F-M8X125I																											
F-M10X125I																											
F-M12X125I																											

### Dimensions

M14\M18\M22\M26

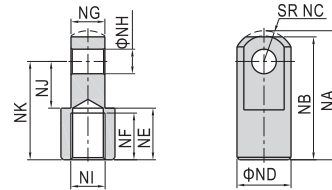

Type/Item	NA	NB	NC	ND	NE	NF	NG	NH	NJ	NK	NI
F-M14X150I	52.5	50	12.5	22	21	19	13.8	10	19	40	M14×1.5
F-M18X150I	66.5	64	16.5	28	27	24	19.8	14	24	50	M18×1.5
F-M22X150I	83.5	80	23.5	40	29	26	29.8	22	34	60	M22×1.5
F-M26X150I	83.5	80	23.5	40	29	26	29.8	22	34	60	M26×1.5

Others

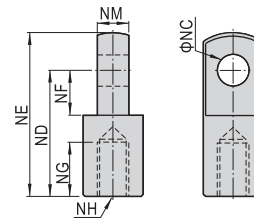

Type/Item	NC	ND	NE	NF	NG	NH	NM
F-M3X050I	3	12	15.5	5	5	M3×0.5	3
F-M4X070I	4	16	21	6.8	8	M4×0.7	4
F-M5X080I	5	25	32	14.1	7.5	M5×0.8	6.3
F-M6X100I	6	21	28	8.5	8	M6×1.0	6
F-M8X125I	8	30	40	11	15	M8×1.25	8
F-M10X125I	10	40	50	15	20	M10×1.25	10
F-M12X125I	12	48	62	24	20	M12×1.25	12
F-M16X150I	16	64	82	32	23	M16×1.5	16
F-M20X150I	20	80	102	40	30	M20×1.5	20
F-M27X200I	30	110	139	51	45	M27×2.0	30
F-M36X200I	35	144	181	65	55	M36×2.0	35
F-M42X200I	40	168	211	85	62	M42×2.0	40



I knuckle