

CE
ISO9001:2008

4V200 Series Solenoid Valve, Air Piloted Valve



4A210-08



4V210-08



4V220-08



4V210-08B



4V210-08



4V230C-08

Ordering Code

| 4V | 2 | 10 | 08 | B | AC220V | W | F |
|--|-------------|--|----------------------|--|--|--|----------|
| Specification | Series Code | Coil and Type | Port size | Connection and Initial Status | Standard Voltage | Wiring | Joint |
| 4V: 5/2 (3) way solenoid valve 4A: 5/2 (3) way air pilot valve 3V: 3/2 way solenoid valve 3A: 3/2 way air pilot valve | 200 Series | 10: Single coil 20: Double coil 30C: Mid-position closed 30E: Mid-position exhausted 30P: Mid-position pressed | 06: 1/8" 08: 1/4" | Blank: Threaded B: Sub-plated mounted (for 5/2,5/3 way only) NC: 3/2 way normal close NO: 3/2 way normal open | DC12V DC24V AC24V 50Hz/60Hz AC110V 50Hz/60Hz AC220V 50Hz/60Hz AC380V 50Hz/60Hz | Blank: Without light terminal LD: Brown with light terminal LD1: White with light terminal W: Lead wire | 1 F-20 F |

Specification

| Model | 4V210-06 | 4V220-06 | 4V230C-06 | 4V230E-06 | 4V230P-06 | 4V210-08 | 4V220-08 | 4V230C-08 | 4V230E-08 | 4V230P-08 |
|------------------------------|--------------------------------------|----------|------------------------------|-----------|-----------|---|----------|------------------------------|-----------|-----------|
| Model | 4A210-06 | 4A220-06 | 4A230C-06 | 4A230E-06 | 4A230P-06 | 4A210-08 | 4A220-08 | 4A230C-08 | 4A230E-08 | 4A230P-08 |
| Valve Type | 5/2 way | | 5/3 way | | | 5/2 way | | 5/3 way | | |
| Effective Cross Section Area | 14 mm ² (CV=0.78) | | 12 mm ² (CV=0.67) | | | 16 mm ² (CV=0.89) | | 12 mm ² (CV=0.67) | | |
| Model | 3V210-06 | 3V220-06 | 3A210-06 | 3A220-06 | | 3V210-08 | 3V220-08 | 3A210-08 | 3A220-08 | |
| Valve Type | 3/2 way | | | | | | | | | |
| Effective Cross Section Area | 14 mm ² (CV = 0.78) | | | | | 16 mm ² (CV = 0.89) | | | | |
| Port Size | Inlet, Outlet, Exhaust Port = G 1/8" | | | | | Inlet, Outlet = G 1/4", Exhaust Port = G 1/8" | | | | |
| Working Medium | 40 Micron Filtered Air | | | | | | | | | |
| Operation | Internal piloted | | | | | | | | | |
| Working-pressure | 0.15 ~ 0.8 MPa | | | | | | | | | |
| Max. Test Pressure | 1.2 MPa | | | | | | | | | |
| Ambient Temperature | 5 ~ 50 °C | | | | | | | | | |
| Operating Voltage Tolerance | ± 10% | | | | | | | | | |
| Power Consumption | AC: 5.5 VA DC: 4.8 W | | | | | | | | | |
| Connector Protection | F Class, IP 65 | | | | | | | | | |
| Wiring / Connector | Cable / Lead Wire or DIN Connector | | | | | | | | | |
| Switching Frequency | 5 Cycles / Sec. | | | | | | | | | |
| Response Time | 0.05 Sec. | | | | | | | | | |

- Valve
- DJF
- JELMP
- JELP/G
- MCS
- 4V100
- 4V200
- 4V300
- 4V400
- Manifold
- SV
- 3V1
- JEL
- 3VJZF
- 4VJZF
- MVSD
- VF, VZ
- BM
- Diaphragm
- Coil
- 2V
- 2W
- 2W(Big)
- 2P
- 2L
- VX
- PU
- PU225
- 2Q
- JEL5404
- JEL6213
- BU
- Pulse
- JELJZF
- 4H
- TSV
- MPV
- 4HV
- HV, K
- 4R
- FV
- MSV
- JM
- ASC, RE
- QE, QEA
- ST
- HSV

4V200 Series

Solenoid Valve, Air Piloted Valve



We make the difference

Overall Dimension

- Valve
- DJF
- JELMP
- JELP/G
- MCS
- 4V100
- 4V200**
- 4V300
- 4V400
- Manifold
- SV
- 3V1
- JEL
- 3VJZF
- 4VJZF
- MVSD
- VF, VZ
- BM
- Diaphragm
- Coil
- 2V
- 2W
- 2W(Big)
- 2P
- 2L
- VX
- PU
- PU225
- 2Q
- JEL5404
- JEL6213
- BU
- Pulse
- JELJZF
- 4H
- TSV
- MPV
- 4HV
- HV, K
- 4R
- FV
- MSV
- JM
- ASC, RE
- QE, QEA
- ST
- HSV

4V210-06

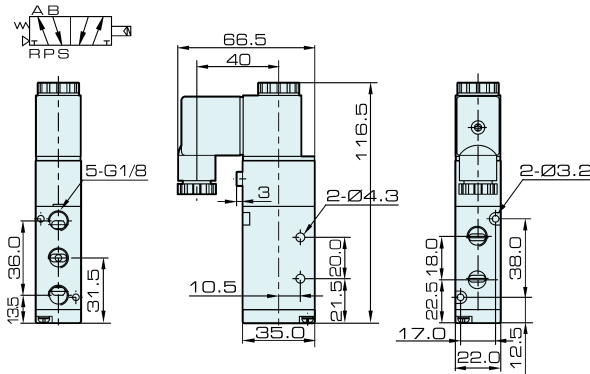

4V210-08

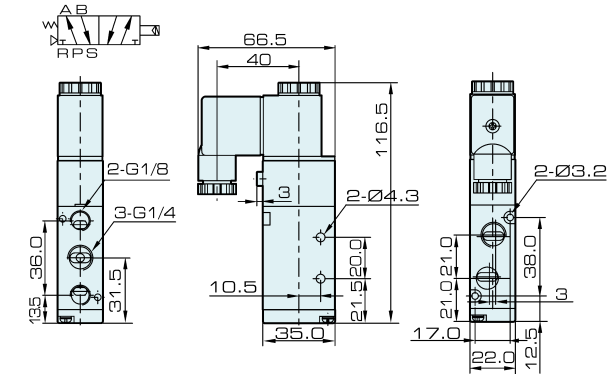

4V220-06

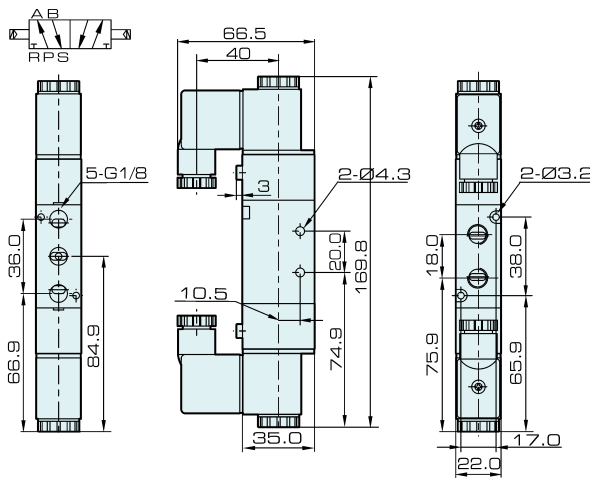

4V220-08

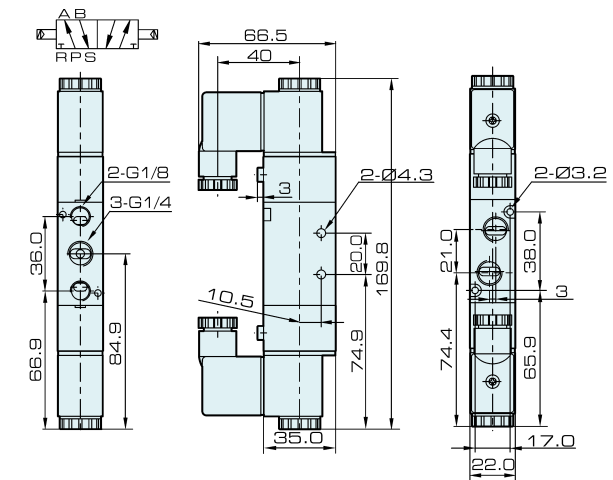

4V230-06

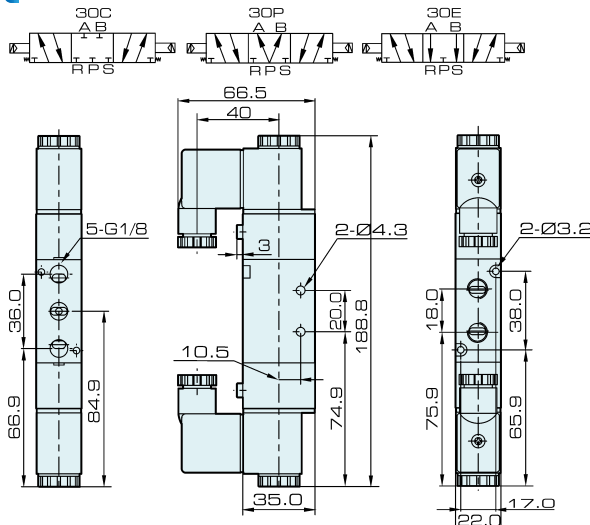

4V230-08

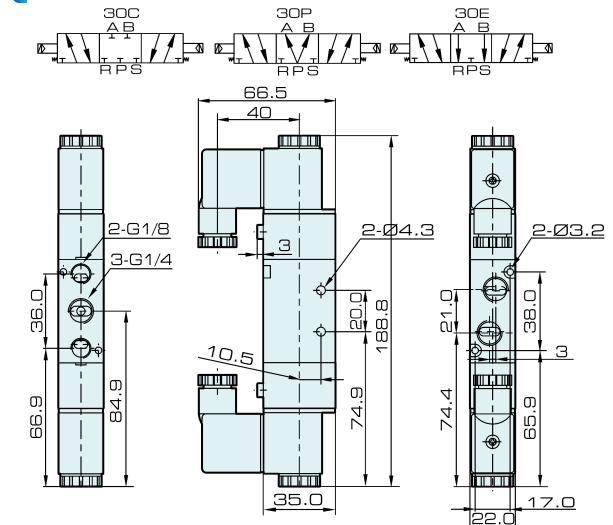

Overall Dimension

4V210-06B

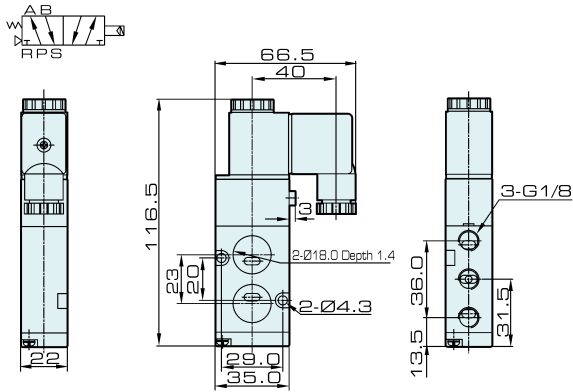

4V210-08B

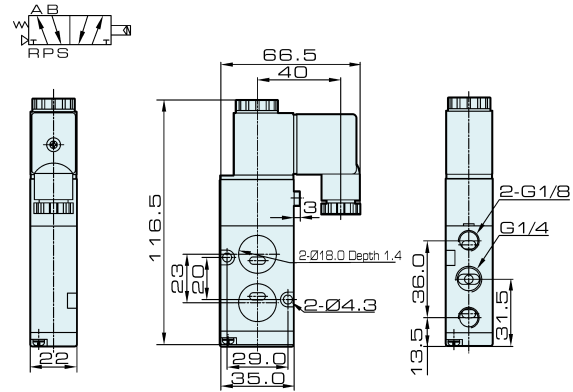

4V220-06B

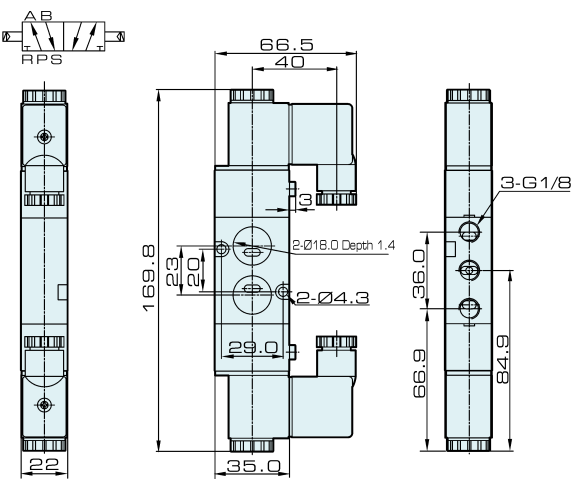

4V220-08B

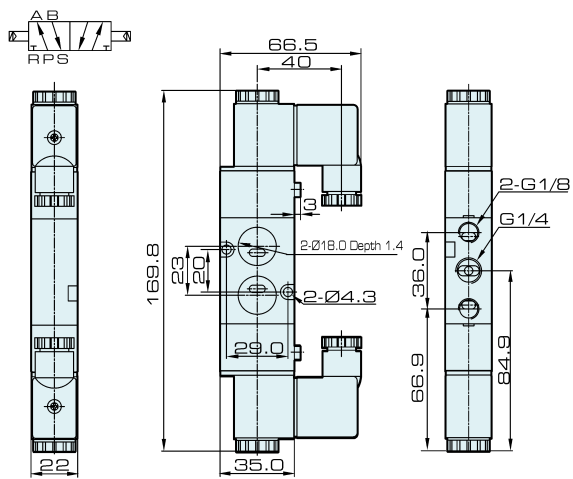

4V230-06B

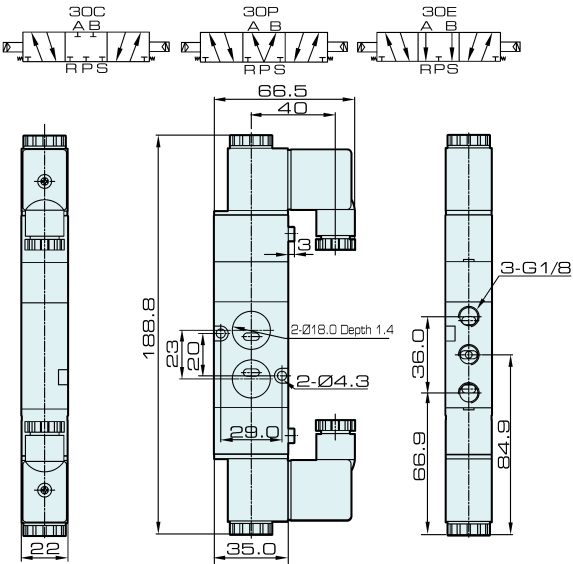

4V230-08B

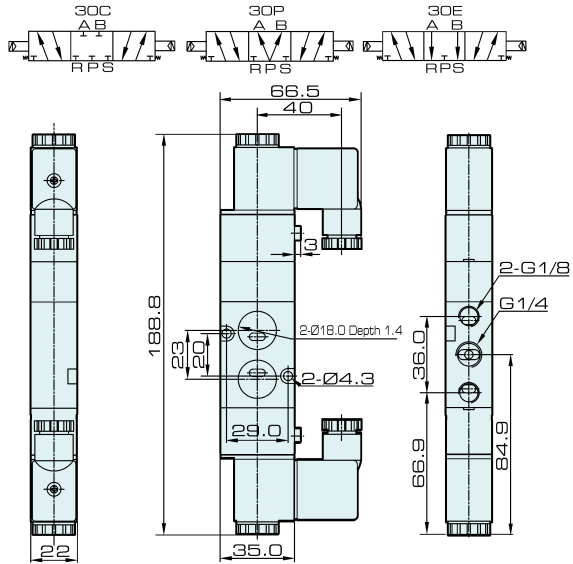

Valve

- DJF
- JELMP
- JELP/G
- MCS
- 4V100
- 4V200**
- 4V300
- 4V400
- Manifold
- SV
- 3V1
- JEL
- 3VJZF
- 4VJZF
- MVSD
- VF, VZ
- BM
- Diaphragm
- Coil
- 2V
- 2W
- 2W(Big)
- 2P
- 2L
- VX
- PU
- PU225
- 2Q
- JEL5404
- JEL6213
- BU
- Pulse
- JELJZF
- 4H
- TSV
- MPV
- 4HV
- HV, K
- 4R
- FV
- MSV
- JM
- ASC, RE
- QE, QEA
- ST
- HSV

4V200 Series

Solenoid Valve, Air Piloted Valve



We make the difference

Overall Dimension

- Valve
- DJF
- JELMP
- JELP/G
- MCS
- 4V100
- 4V200**
- 4V300
- 4V400
- Manifold
- SV
- 3V1
- JEL
- 3VJZF
- 4VJZF
- MVSD
- VF, VZ
- BM
- Diaphragm
- Coil
- 2V
- 2W
- 2W(Big)
- 2P
- 2L
- VX
- PU
- PU225
- 2Q
- JEL5404
- JEL6213
- BU
- Pulse
- JELJZF
- 4H
- TSV
- MPV
- 4HV
- HV, K
- 4R
- FV
- MSV
- JM
- ASC, RE
- QE, QEA
- ST
- HSV

4A210-06

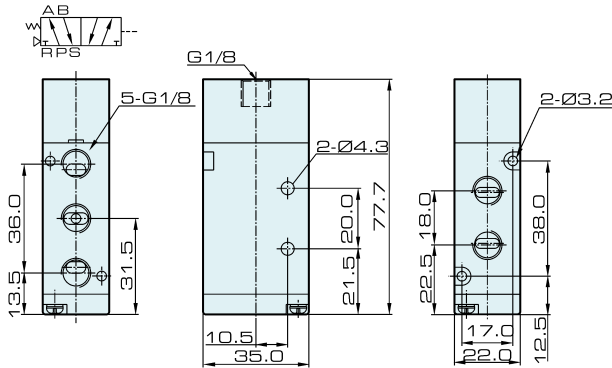

4A210-08

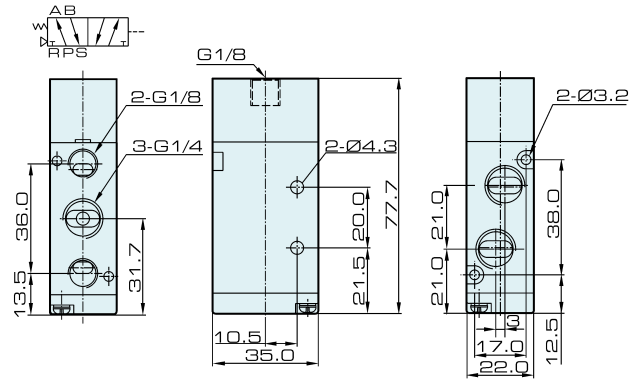

4A220-06

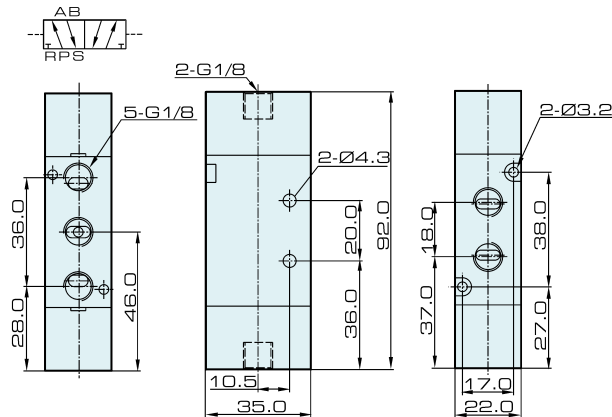

4A220-08

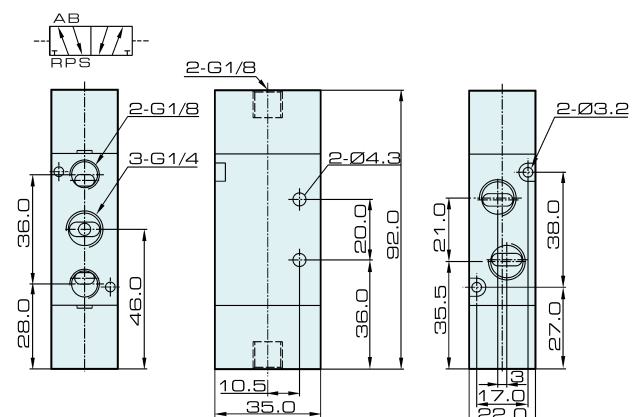

4A230-06

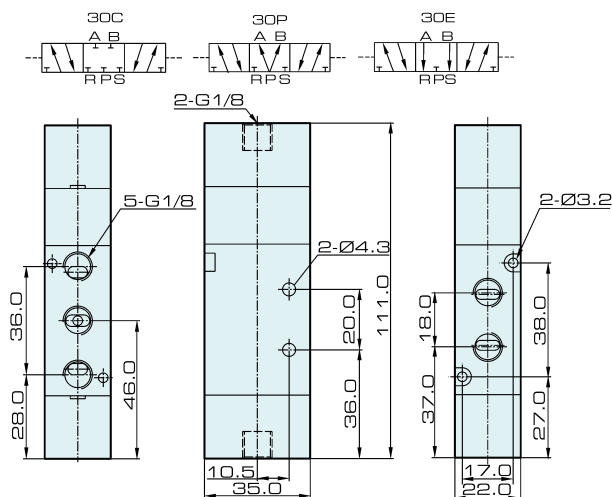

4A230-08

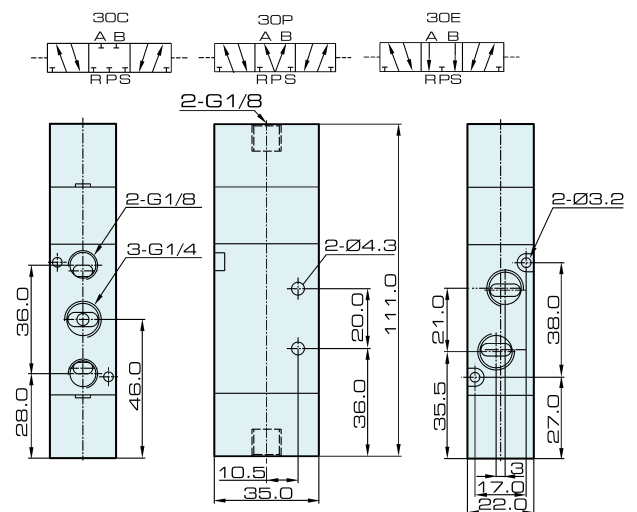

Overall Dimension

3V210-06

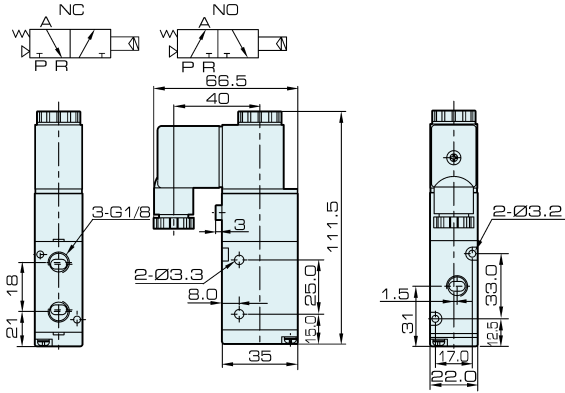

3V210-08

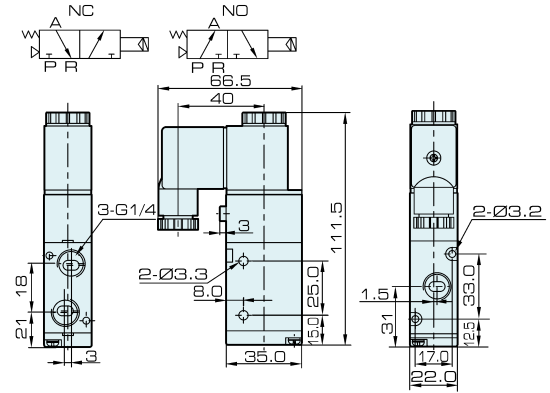

3V220-06

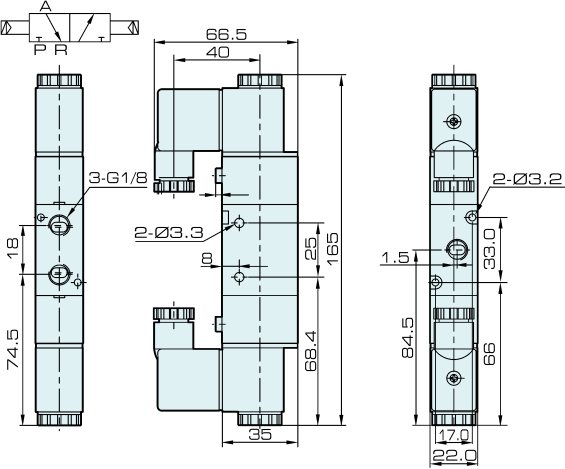

3V220-08

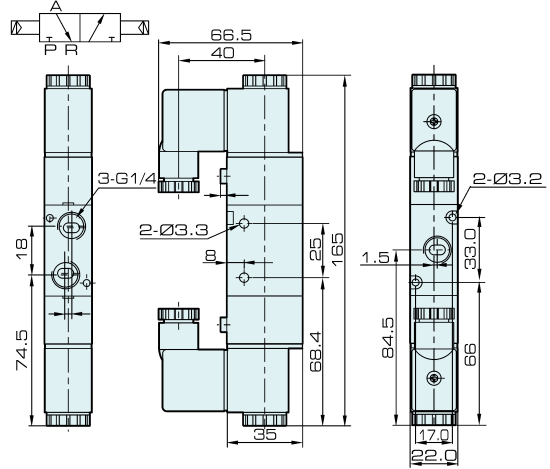

3A210-06

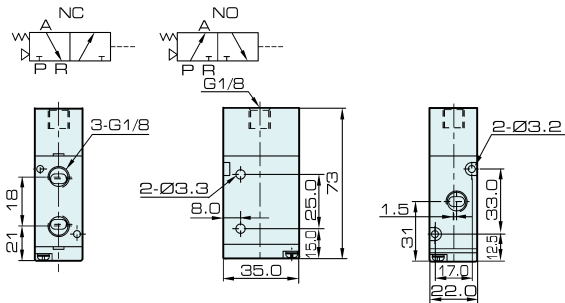

3A210-08

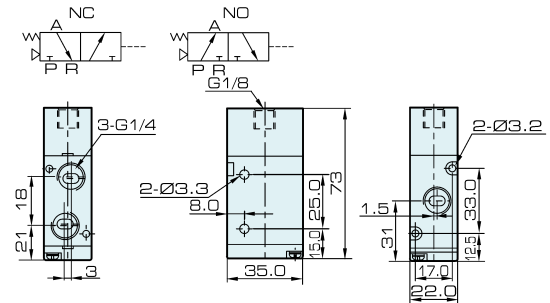

3A220-06

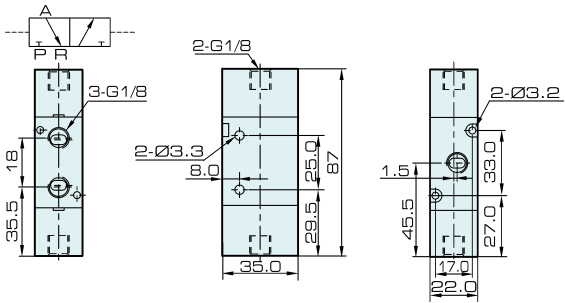

3A220-08

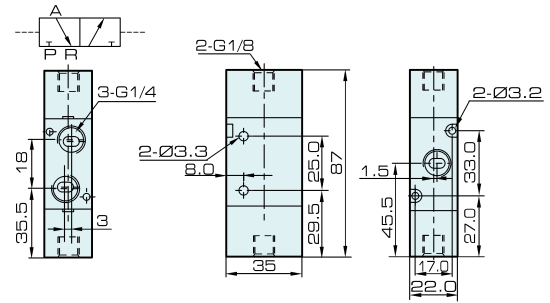

- Valve
- DJF
- JELMP
- JELP/G
- MCS
- 4V100
- 4V200
- 4V300
- 4V400
- Manifold
- SV
- 3V1
- JEL
- 3VJZF
- 4VJZF
- MVSD
- VF, VZ
- BM
- Diaphragm
- Coil
- 2V
- 2W
- 2W(Big)
- 2P
- 2L
- VX
- PU
- PU225
- 2Q
- JEL5404
- JEL6213
- BU
- Pulse
- JELJZF
- 4H
- TSV
- MPV
- 4HV
- HV, K
- 4R
- FV
- MSV
- JM
- ASC, RE
- QE, QEA
- ST
- HSV