

4V300 Series

Solenoid Valve, Air Piloted Valve



We make the difference

Valve

DJF

JELMP

JELP/G

MCS

4V100

4V200

4V300

4V400

Manifold

SV

3V1

JEL

3VJZF

4VJZF

MVSD

VF, VZ

BM

Diaphragm

Coil

2V

2W

2W(Big)

2P

2L

VX

PU

PU225

2Q

JEL5404

JEL6213

BU

Pulse

JELJZF

4H

TSV

MPV

4HV

HV, K

4R

FV

MSV

JM

ASC, RE

QE, QEA

ST

HSV



Ordering Code

4V	3	10	10	B	AC220V	W	F
Specification	Series Code	Coil and Type	Port size	Connection and Initial status	Standard Voltage	Wiring	Joint
4V: 5/2 (3) way solenoid valve 4A: 5/2 (3) way air pilot valve 3V: 3/2 way solenoid valve 3A: 3/2 way air pilot valve	300 Series	10: Single coil 20: Double coil 30C: Mid-position closed 30E: Mid-position exhausted 30P: Mid-position pressed	08: 1/4" 10: 3/8"	Blank: Threaded B: Sub-plated mounted (for 5/2,5/3 way only) NC: 3/2 way normal close NO: 3/2 way normal open	DC12V DC24V AC24V 50Hz/60Hz AC110V 50Hz/60Hz AC220V 50Hz/60Hz AC380V 50Hz/60Hz	Blank: Without light terminal LD: Brown with light terminal LD1: White with light terminal W: Lead wire	1 F-20 F

Specification

Model	4V310-08	4V320-08	4V330C-08	4V330E-08	4V330P-08	4V310-10	4V320-10	4V330C-10	4V330E-10	4V330P-10
Valve Type	5/2 way			5/3 way		5/2 way		5/3 way		
Effective Cross Section Area	25 mm ² (CV = 1.40)			18 mm ² (CV = 1.00)		30 mm ² (CV = 1.68)		18 mm ² (CV = 1.00)		
Model	3V310-08	3V320-08	3A310-08	3A320-08	3V310-10	3V320-10	3A310-10	3A320-10		
Valve Type	3/2 way									
Effective Cross Section Area	25 mm ² (CV = 1.40)					30 mm ² (CV = 1.68)				
Port Size	Inlet, Outlet, Exhaust Port = G 1/4"					Inlet, Outlet = G 3/8" Exhaust Port = G 1/4"				
Working Medium	40 Micron Filtered Air									
Operation	Internal piloted									
Working-pressure	0.15 ~ 0.8 MPa									
Max. Test Pressure	1.2 MPa									
Ambient Temperature	5 ~ 50 °C									
Operating Voltage Tolerance	± 10%									
Power Consumption	AC: 5.5 VA DC: 4.8 W									
Connector Protection	F Class, IP 65									
Wiring/Connector	Cable / Lead Wire or DIN Connector									
Switching Frequency	5 Cycles / Sec.									
Response Time	0.05 Sec.									

4V300 Series

Solenoid Valve, Air Piloted Valve

Overall Dimension

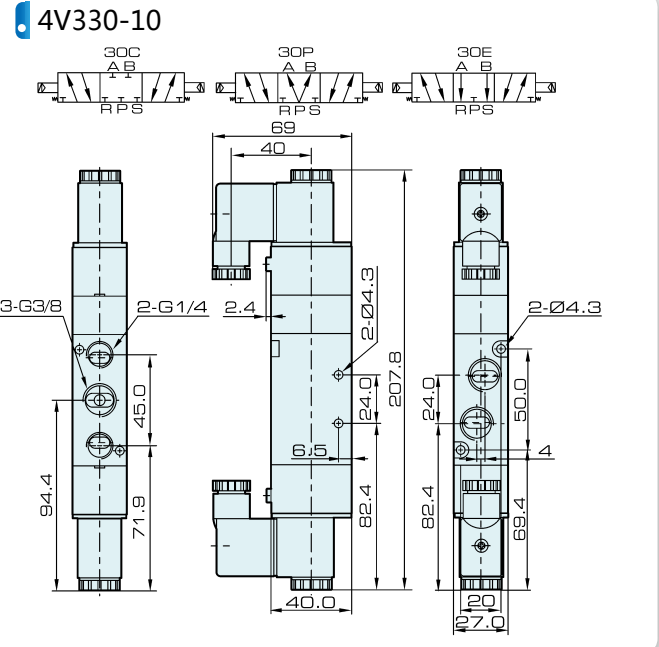
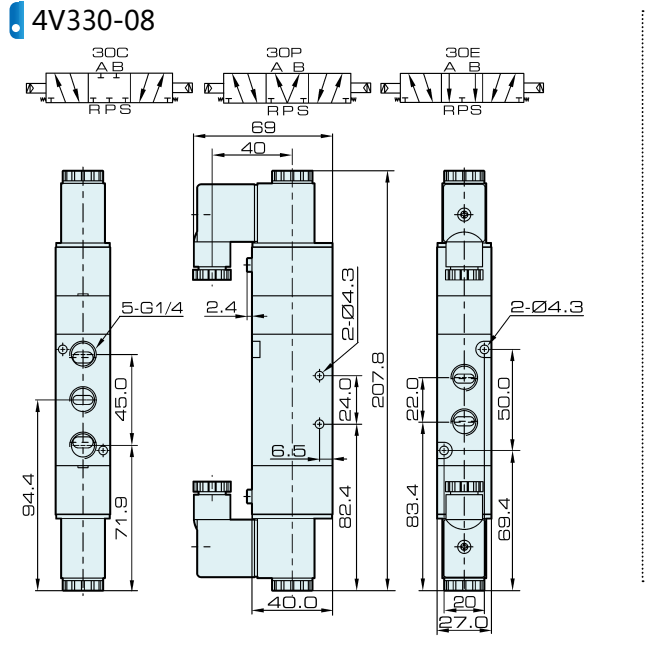
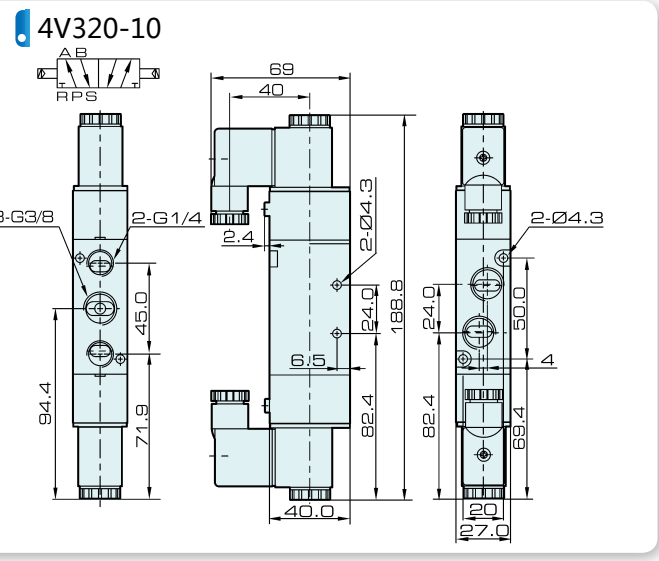
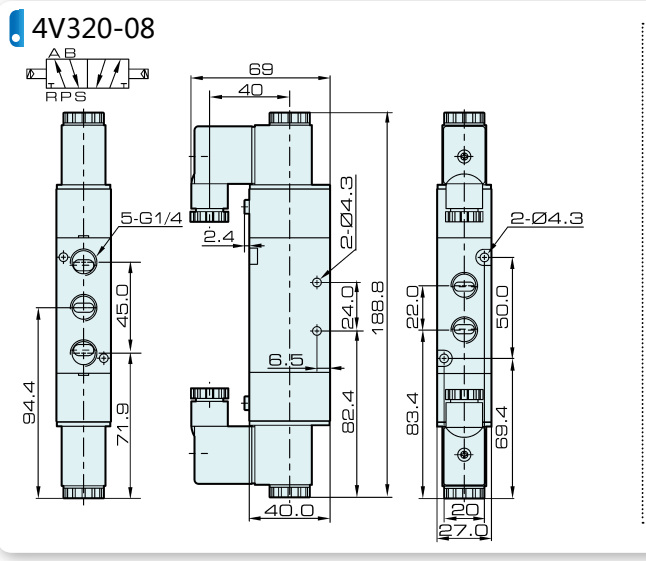
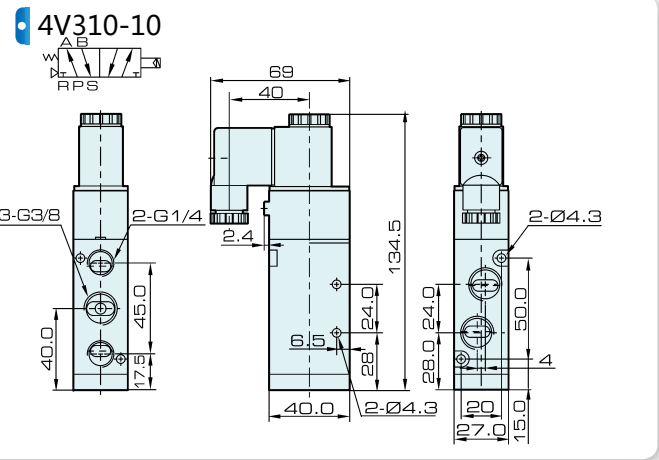
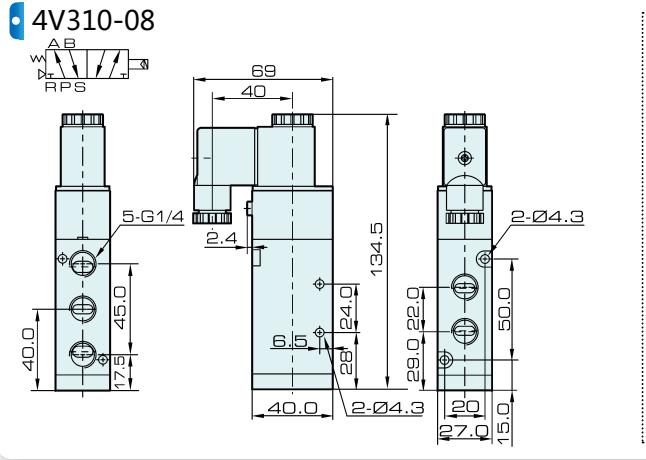

Valve

- DJF
- JELMP
- JELP/G
- MCS
- 4V100
- 4V200
- 4V300**
- 4V400
- Manifold
- SV
- 3V1
- JEL
- 3VJZF
- 4VJZF
- MVSD
- VF, VZ
- BM
- Diaphragm
- Coil
- 2V
- 2W
- 2W(Big)
- 2P
- 2L
- VX
- PU
- PU225
- 2Q
- JEL5404
- JEL6213
- BU
- Pulse
- JELJZF
- 4H
- TSV
- MPV
- 4HV
- HV, K
- 4R
- FV
- MSV
- JM
- ASC, RE
- QE, QEA
- ST
- HSV

4V300 Series

Solenoid Valve, Air Piloted Valve



We make the difference

Overall Dimension

- Valve
- DJF
- JELMP
- JELP/G
- MCS
- 4V100
- 4V200
- 4V300
- 4V400
- Manifold
- SV
- 3V1
- JEL
- 3VJZF
- 4VJZF
- MVSD
- VF, VZ
- BM
- Diaphragm
- Coil
- 2V
- 2W
- 2W(Big)
- 2P
- 2L
- VX
- PU
- PU225
- 2Q
- JEL5404
- JEL6213
- BU
- Pulse
- JELJZF
- 4H
- TSV
- MPV
- 4HV
- HV, K
- 4R
- FV
- MSV
- JM
- ASC, RE
- QE, QEA
- ST
- HSV

4V310-08B

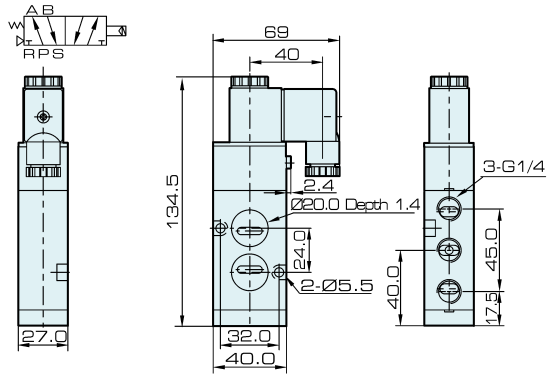

4V310-10B

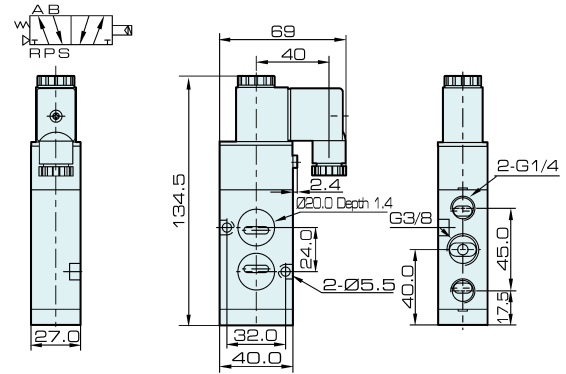

4V320-08B

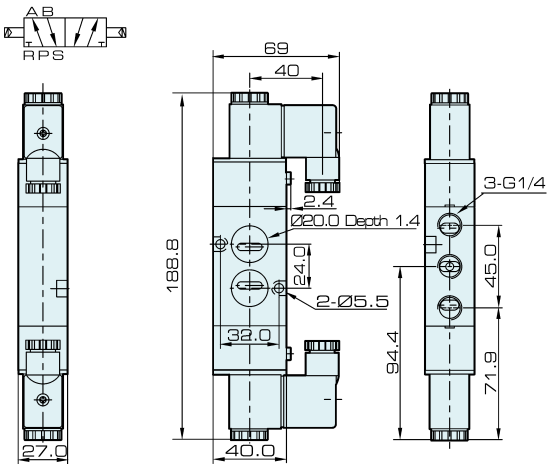

4V320-10B

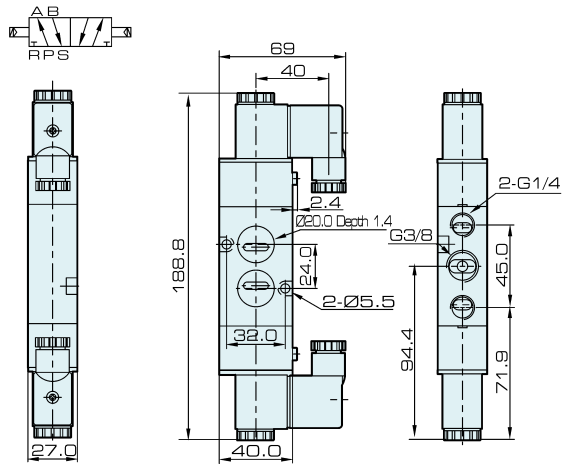

4V330-08B

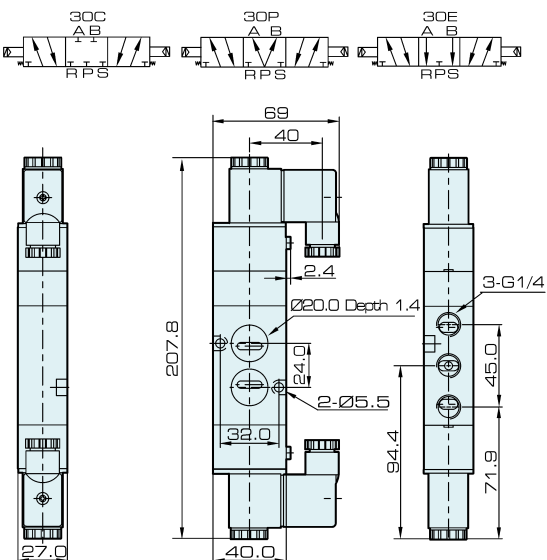

4V330-10B

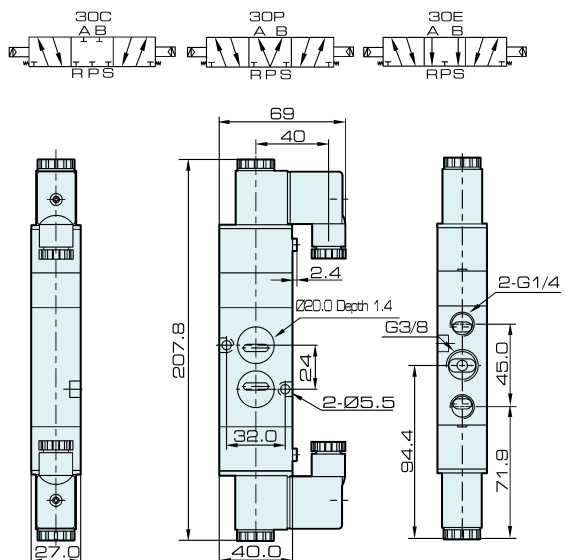

4V300 Series

Solenoid Valve, Air Piloted Valve

Overall Dimension

4A310-08

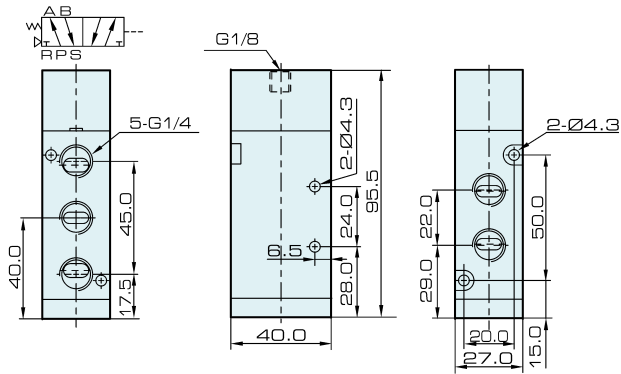

4A310-10

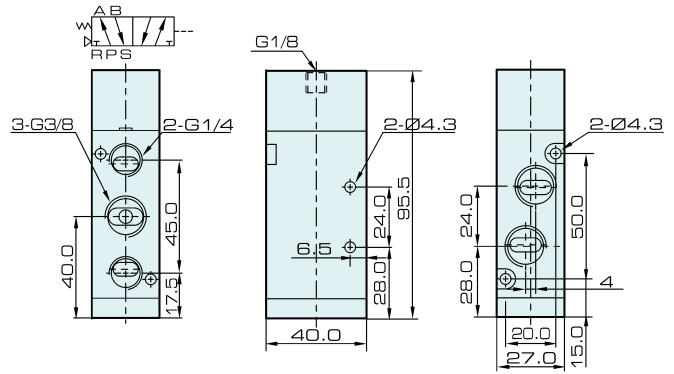

4A320-08

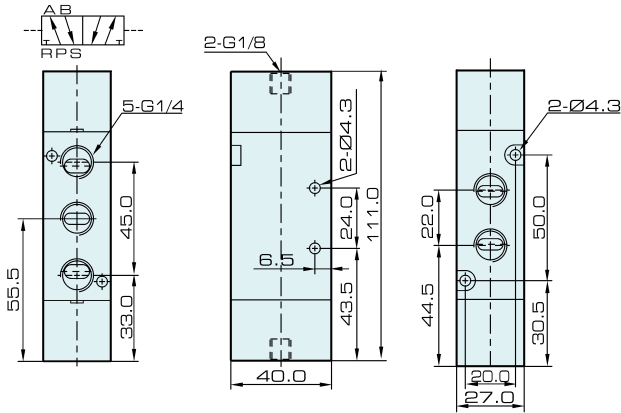

4A320-10

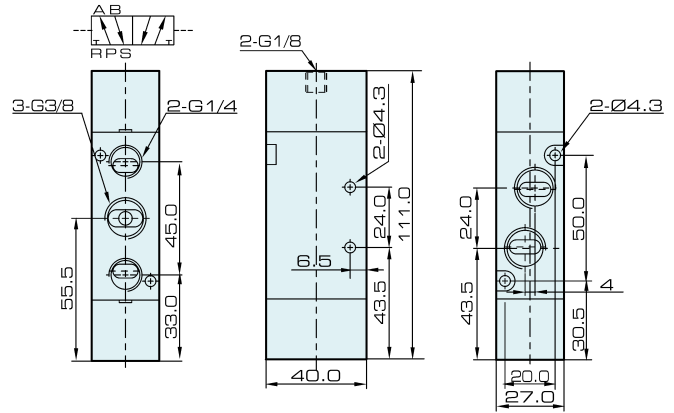

4A330-08

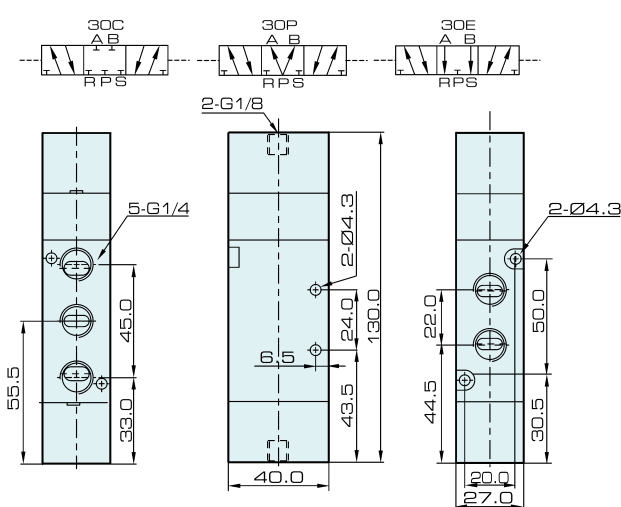

4A330-10

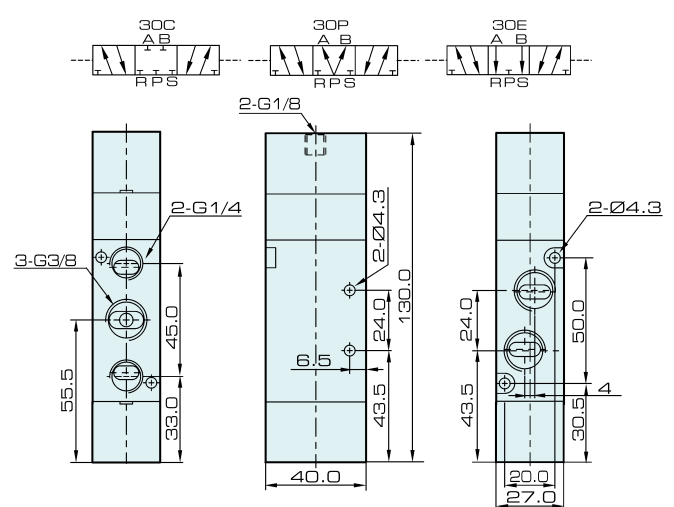

Valve

- DJF
- JELMP
- JELP/G
- MCS
- 4V100
- 4V200
- 4V300
- 4V400
- Manifold
- SV
- 3V1
- JEL
- 3VJZF
- 4VJZF
- MVSD
- VF, VZ
- BM
- Diaphragm
- Coil
- 2V
- 2W
- 2W(Big)
- 2P
- 2L
- VX
- PU
- PU225
- 2Q
- JEL5404
- JEL6213
- BU
- Pulse
- JELJZF
- 4H
- TSV
- MPV
- 4HV
- HV, K
- 4R
- FV
- MSV
- JM
- ASC, RE
- QE, QEA
- ST
- HSV

4V300 Series

Solenoid Valve, Air Piloted Valve



We make the difference

Overall Dimension

- Valve
- DJF
- JELMP
- JELP/G
- MCS
- 4V100
- 4V200
- 4V300
- 4V400
- Manifold
- SV
- 3V1
- JEL
- 3VJZF
- 4VJZF
- MVSD
- VF, VZ
- BM
- Diaphragm
- Coil
- 2V
- 2W
- 2W(Big)
- 2P
- 2L
- VX
- PU
- PU225
- 2Q
- JEL5404
- JEL6213
- BU
- Pulse
- JELJZF
- 4H
- TSV
- MPV
- 4HV
- HV, K
- 4R
- FV
- MSV
- JM
- ASC, RE
- QE, QEA
- ST
- HSV

3V310-08

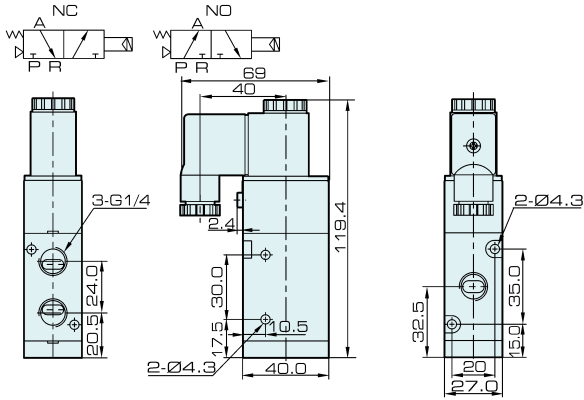

3V310-10

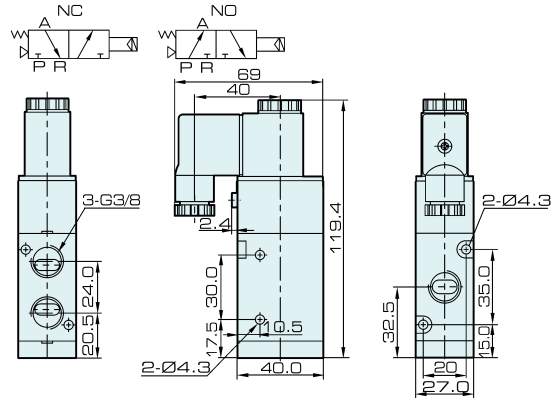

3V320-08

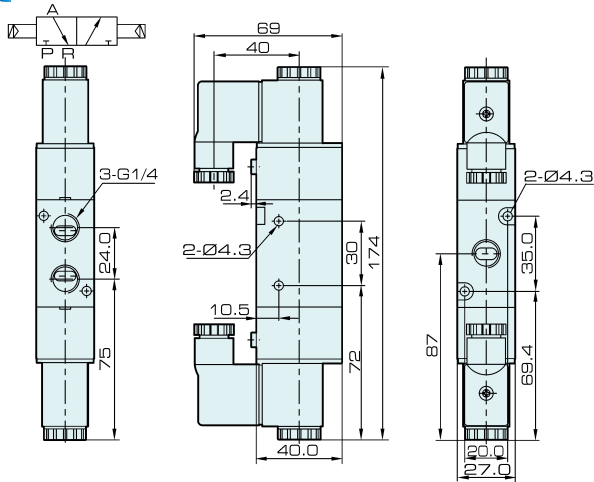

3V320-10

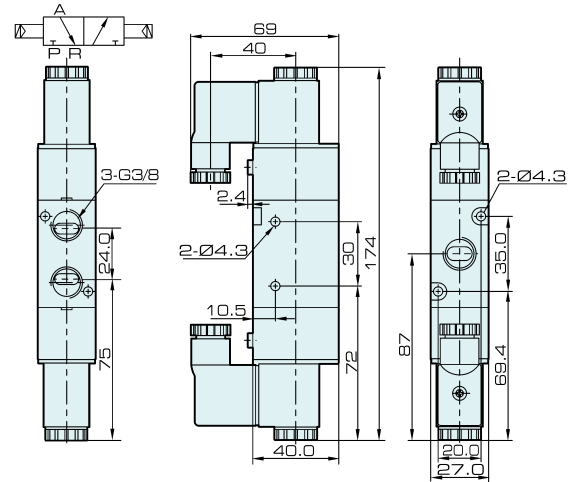

3A310-08

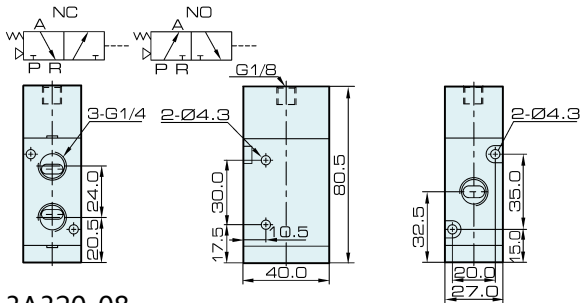

3A310-10

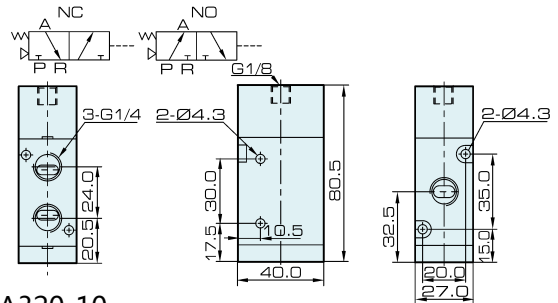

3A320-08

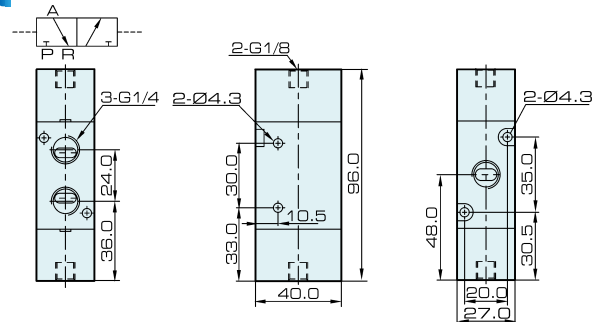

3A320-10

